



The pursuit of
excellence from Germany



Dealer:



WWW.DOORLIFTER.COM
E-mail: ider@doorlifter.com



JIAXING IDER ELECTRONIC TECHNOLOGY CO., LTD.

Contents

About IDER	01-02
Workshop/ Engineering Cases	03-04

SECTIONAL Industrial Door Operator

G Series (30N.m~70N.m)	05-06
GYM Series (35N.m~150N.m)	07-08
GYM Series (200N.m)	09-10
GYM Series (260N.m~650N.m)	11-12
GYM Series (800N.m~1000N.m)	13
GYM Series (1500N.m~2000N.m)	14
GYM Series (40N.m~150N.m)	15-16
GYM Series (180N.m~40N.m)	17-18
GYM-SF Series (50N.m~200N.m)	19-20
GYM-SF Series (300N.m~800N.m)	21
GYM-SF Series (1000N.m~2000N.m)	22
GYM-SFL Series (30N.m~120N.m)	23-24

ROLLER SHUTTER Door Operator

GYM Series (200N.m~650N.m)	25-26
GYM Series (800N.m~1000N.m)	27
GYM Series (1500N.m~2000N.m)	28
GYM-SF Series (300N.m~1000N.m)	29
GYM-SF Series (1500N.m~2000N.m)	30

SLIDING Industrial Door Operator

GYT Series (800Kg~2500Kg)	31-32
-----------------------------	-------

EXPLOSION Proof Door Operator

GYF Series	33-34
------------	-------

HIGH SPEED Door Operator

GYJ Series (40N.m~150N.m)	35-36
GYJ-SF Series (550W~2200W) PVC Door	37
GYJ-SF Series (750W~2200W) Spiral Door	38

Control System

Control System Combination	39-40
Docking Leveller Control System Combination	41
Motor & Controller Selection	42

SLIDING Door Operator

PYM Series (600Kg~1000Kg)	43
PYM Series (1500Kg~2500Kg)	44

SWING Door Operator

ZK300DC	45
ZK800/ZK1000	46

FOLDING Door Operator

FK400	47
FK800/FK1000/FK600DC	48

GARAGE Door Operator

CKM Series (600N~1800N)	49
GYZ Series (1000N~1500N)	50

BARRIER Boom Gate

DCSF Series (3m~6m)	51-52
-----------------------	-------

Components

Industrial Door OperatorComponents	53-54
------------------------------------	-------



About IDER

IDER Technology is a technology-oriented enterprise engaged in R&D, manufacturing and sales of industry Door Operator and electric control system in China. Through 20 years of effort, the company has accumulated rich industrial experience in manufacturing Industrial Door Operator and High Speed Door Operator with Electric limit and Encoder Limit by Frequency Conversion motor docking leveler with professional R&D team and internationally-advanced technology, the company is engaged in R&D and manufacturing of AC/DC industrial door operators, high speed door motor and other door operator.

Main Product: Industrial Sectional Door Drives; High Line door operator; Industrial Flange Motor; Industrial Direct Drives Motor; Industrial Chain Drive Motor; AC/DC High Speed Door Motor; Servo High Speed Door Motor; High-Performance Doors Operator; Direct Drive Operator Chain Drive Operator; Loading Dock Leveler Controller; Sliding Gate Operator& Controll.

The self-developed industrial door operator high speed door motor and electric control systems, etc. are characterized by handsome appearance, exquisite workmanship, compact structure, stable property and multiple varieties, and meet various installation requirements at various occasions. Our products are widely applied to airport, logistics center, industrial workshop, refrigeration storage, etc. Our products have passed the EU CE certification and certifications of domestic authorized testing organizations, and are very popular at home and abroad.

The company pursues the perfection of products, pays attention to every detail of products, whether it is product appearance design, structure design, manufacturing process control, quality inspection and so on are strictly in accordance with the European standards. "First-class products, thoughtful service, value of the concept" Is our pursuit, we strive to provide reliable door opener series products for domestic and foreign partners.

The company is located in Zhejiang China, We sincerely welcome domestic and foreign industry colleagues, to visit the guidance.



Certificate



Certificate



ISO9001
Quality Management Certification

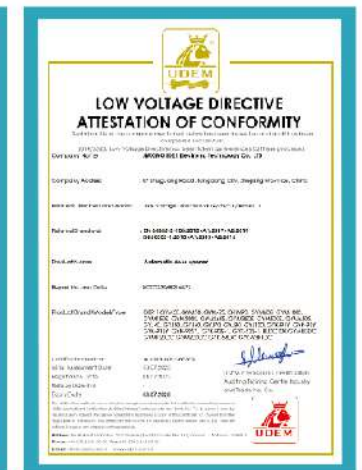
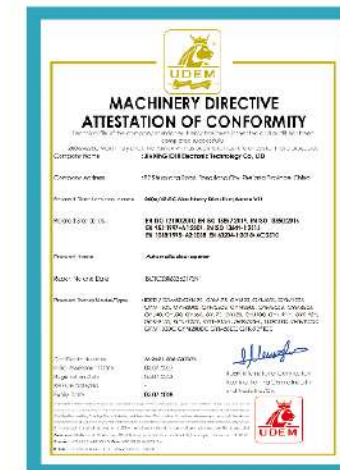

CE Certificate



Brand Authorization Certificate



Product Patent Certificate



Product Testing Report

■ Engineering Cases



Assembly area



Assembly workshop



Processing area



Detection zone



Exhibition



Beijing



Kunming



Nanjing



Hangzhou



Shenyang

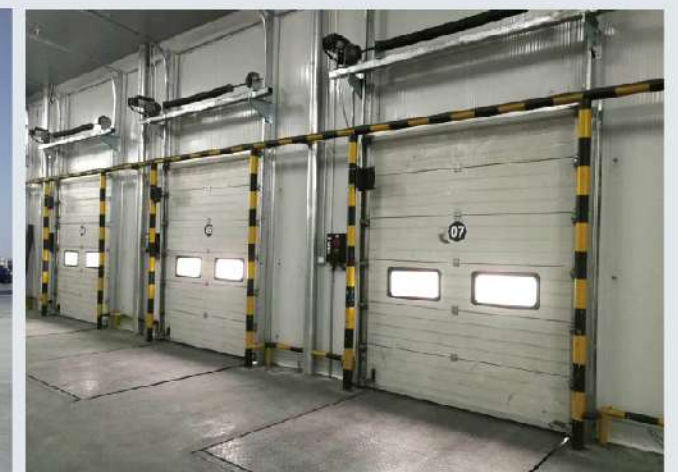

Shanghai

SECTIONAL Industrial Door Operator

(AC motor)

G Series (30N.m~70N.m)



Split type control

Inter lock type control

Integrated type control

■ Advantage

- The reduction gearbox adopts precision worm gear and worm drive and oil-immersed
- lubrication, smooth transmission low noise, long service life;
- Built-in limit, the structure is more compact more convenient adjustment;
- Unique quick release mechanism convenient operate door in an emergency
- According to different structure can choose the on load bearing or down bearing installation;
- Can choose according to need to use split type electric control, inter-lock control or all-in-one control;
- Control box with infrared, PNEUMO Switch and so on the many kinds of protection terminal interface;

■ Performance Parameter

Model	G35-2	G45-2	G40S-2	G70S-2
Input Voltage	AC230V 50/60Hz		AC400V 50/60Hz	
Rated Power	250W	300W	250W	400W
Startup Torque	30N.m	35N.m	40.m	70N.m
No-load Running Time	15min	15min	25min	25min
Maximum Door Weight	15m ²	20m ²	20m ²	30m ²
Diameters of the hole for output shaft	Φ25.4mm			
Retarding Mechanism	Mechanism completely built with cooper worm wheels and worm rods			
No-load Rotating Speed	24r/min			
Lubrication	Oil submerging			
Thermal Protective Temperature	120°C			
Max. Limited Journey	20 rounds rotation of the output shaft			
Ambient Temperature	-20°C~+45°C			
Working System	S2 20%			
Noise	≤55dB			
Protective level	IP 54			
Mode of supportive power-control	Split type			
Mode of manual chain	Universal chain style			
Operation mode	Standard			
Type of limit switch	Electronic limit			
Total weight	12kg	13kg	12kg	12kg

■ Dimensions

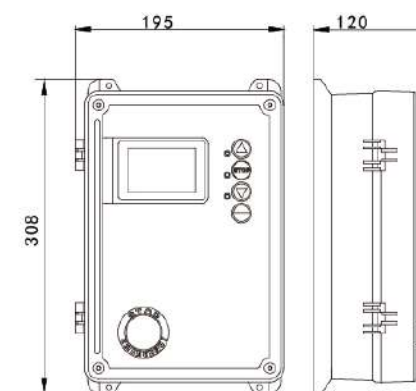
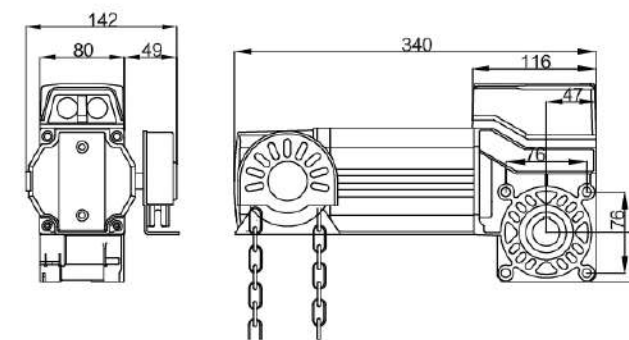

■ Characteristics

- Can achieve dual control of sliding doors and unloading platforms;
- Human machine interface, through digital display function, enables information exchange between humans and machines;
- It can display the operating status of the door body;
- Fault code display helps in fault identification and troubleshooting;
- Interface with safety protection functions such as airbags and infrared;
- Earthing magnet and Door security can realize unmanned management and automatic door opening and closing;
- Equipped with fire linkage interface to achieve linkage control with fire protection;
- Provide 220V air curtain interface;



SECTIONAL Industrial Door Operator

(AC motor)

GYM Series (35N.m~150N.m)



■ Selection Motor Performance & Configuration

Mechanical limit
Double limit protection, more safe and reliable

Electronic limit
Lead to adopt high precision 14 absolute encoder (16000 pulse point) of electronic limit mechanism. A greater degree of improve the precision of limit.

Plastic cover can change

Quick Release(Optional)

Semi-Auto Release

Auto Release
Chain release 360° release

■ Performance Parameter

Model	GYM50	GYM70	GYM100	GYM60S	GYM100S	GYM150S
Input voltage	AC230V 50/60Hz			AC400V 50/60Hz		
Rated power	300W	500W	700W	300W	450W	650W
Startup torque	35N.m	60N.m	100N.m	60N.m	100N.m	150N.m
No-load running time	15min	15min	10min	25min	25min	25min
Maximum door weight	20m ²	25m ²	35m ²	25m ²	35m ²	40m ²
Thermal protective temperature	120°C					
Retarding mechanism	Mechanism completely built with cooper worm wheels and worm rods					
No-load rotating speed	24r/min					
Lubrication	Oil submerging					
Noise	≤55dB					
Mode of manual chain	Universal chain style					
Swift release upon power failure	Pull-rope release (optional)					
Max. Limited journey	20 rounds rotation of the output shaft					
Type of limit switch	Mechanical limit / Electronic limit					
Diameters of the hole for output shaft	Φ25.4mm/Φ31.75mm					
Ambient temperature	-20°C ~ +45°C					
Working system	S2 20%					
Protective level	IP54					
Total weight	13KG	14KG	13KG	14KG	15KG	15KG

■ Dimensions

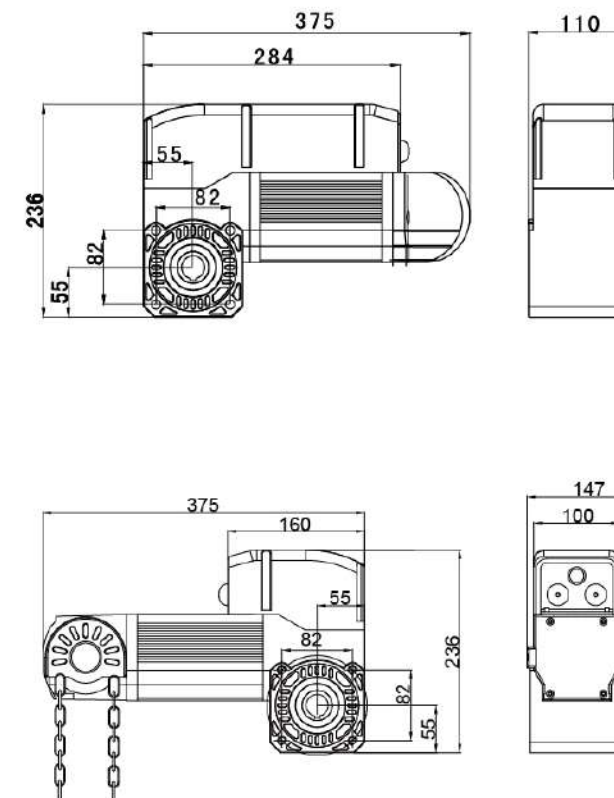

■ Characteristics

- The phase sequence automatic detection function, ensure the door moving in the right direction;
- With a door in door interlock protection function interface
- With infrared, Pneumo Switch and other safety protection function interface
- Can receive magnetism, entrance guard system, realizes the unmanned management, automatic open and close the doors;
- Can set shut down door inching function, used for special occasions.

SECTIONAL Industrial Door Operator (AC motor)

GYM Series (200N.m)



■ Selection Motor Performance & Configuration

Double limit protection more safe and reliable

Lead to adopt high precision 14 absolute encoder (16000 pulse point) of electronic limit mechanism. A greater degree of improve the precision of limit.

The reduction gearbox adopts precision worm gear and worm drive and oil-immersed lubrication, smooth transmission, low noise, long service life;

Anti-fall safeguard Safety brake systems inside reducer

Semi-Auto Release

Auto Release Chain release 360° release

■ Performance Parameter

Model	GYM200S
Input Voltage	AC400V 50/60Hz
Rated Power	800W
Startup Torque	2.5A
No-load Running Time	200N.m
Maximum Door Weight	25min
Mode of supportive power-control	60m ²
Thermal Protective Temperature	120°C
Retarding Mechanism	Mechanism completely built with cooper worm wheels and worm rods
No-load Rotating Speed	22r/min
Lubrication	Oil submerging
Noise	≤55bB
Mode of manual chain	Universal chain style
Max. Limited Journey	20 rounds rotation of the output shaft
Type of limit switch	Mechanical limit /Electronic limit
Diameters of the hole for output shaft	φ25.4mm/31.8mm
Ambient Temperature	-20°C ~ +45°C
Working System	S2 20% / S3 60%
Protective level	IP54
Total weight	26Kg

■ Dimensions

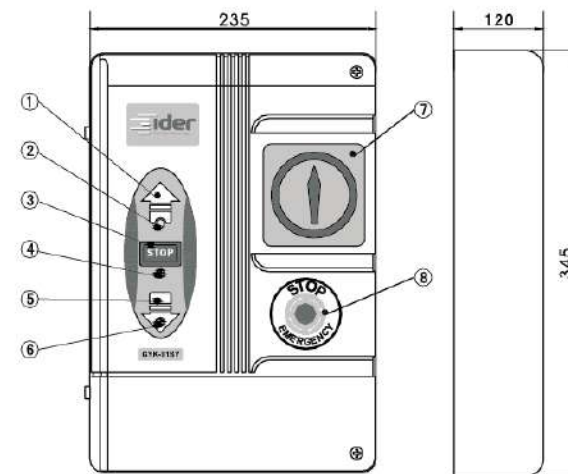
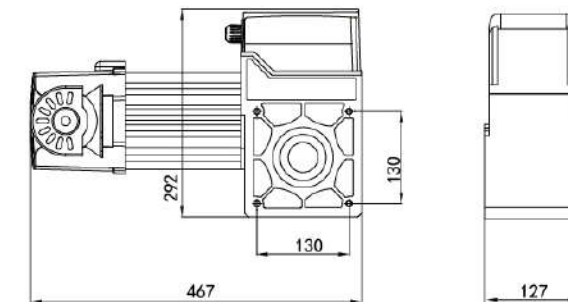

- ① Door opening button ② Door opening indicator ③ Stop button ④ Stop indicator
⑤ Door-closing button ⑥ Door-closing indicator ⑦ Power switch(optional) ⑧ Emergency stop button



■ Characteristics

- The man-machine interface, through digital display function, realizes the person and the equipment information exchange
- Can display running state of the door
- Can display the equipment failure code convenient maintenance
- With More than the limit protection function, prevent door overshoot
- With a door in door interlock protection function interface;
- With infrared, Pneumo Switch and other safety protection function interface.
- Can receive magnetism, entrance guard system, realizes the unmanned management, automatic open and close the doors;
- Can set shut down inching function, used for special occasions
- With single key cycle control function
- Collaborate with the encoder to directly set the travel limit of the door opener on the control panel

SECTIONAL Industrial Door Operator

(AC motor)

GYM Series (260N.m~650N.m)

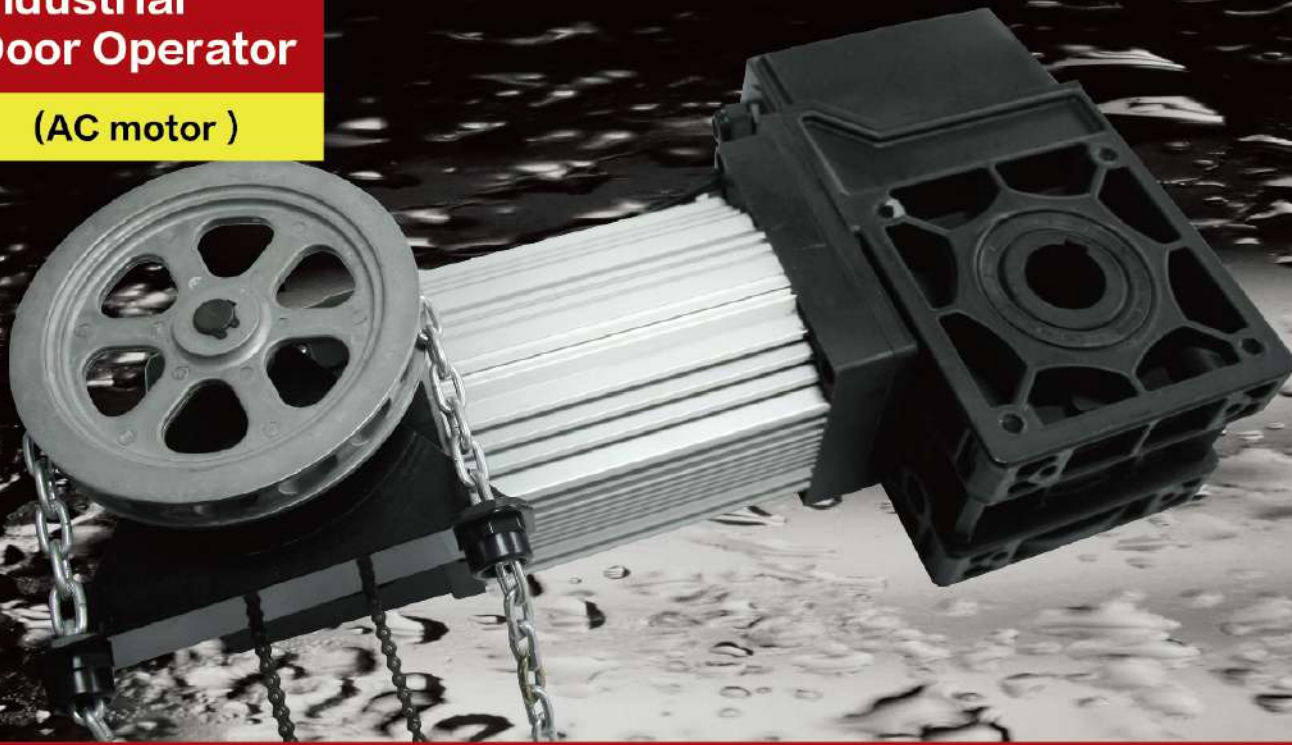

■ Selection Motor Performance & Configuration



■ Performance Parameter

Model	GYM260S	GYM350S	GYM500S	GYM650S				
Input Voltage	AC400V 50/60Hz	AC400V 50/60Hz	AC400V 50/60Hz	AC400V 50/60Hz				
Rated Power	800W	1000W	1200W	1500W				
Startup Torque	260N.m	350N.m	500N.m	650N.m				
No-load Running Time	25min	25min	25min	25min				
No-load Rotating Speed	12r/min	12r/min	12r/min	8r/min				
Rated current	3.5A	3.5A	3.5A	4.5A				
Maximum Door Weight	50m ²	70m ²	100m ²	120m ²				
Mode of supportive power-control	Split type							
Thermal Protective Temperature	120°C							
Retarding Mechanism	Mechanism completely built with cooper worm wheels and worm rods							
Lubrication	Oil submerging							
Noise	≤60dB							
Mode of manual chain	Semi-automatic manual chain mechanism							
Max. Limited Journey	24 rounds rotation of the output shaft							
Type of limit switch	Mechanical limit	Electronic limit	Mechanical limit	Electronic limit	Mechanical limit	Electronic limit	Mechanical limit	Electronic limit
Diameters of the hole for output shaft	φ 25.4、φ 31.75、φ 40							
Ambient Temperature	-20°C~+45°C							
Working System	S2 20% / S3 60%							
Protective level	IP54							
Total weight	26Kg	28Kg	30Kg	32Kg				

■ Dimensions

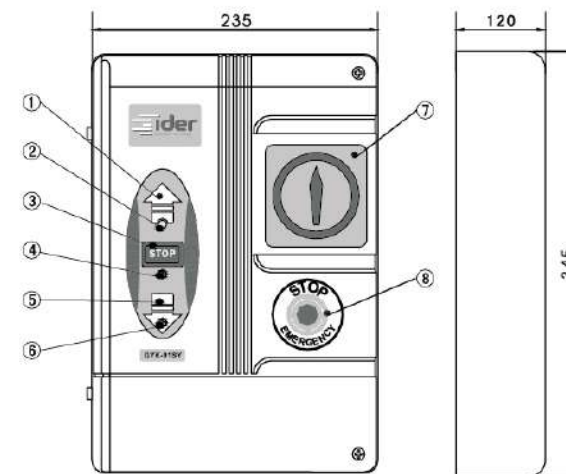
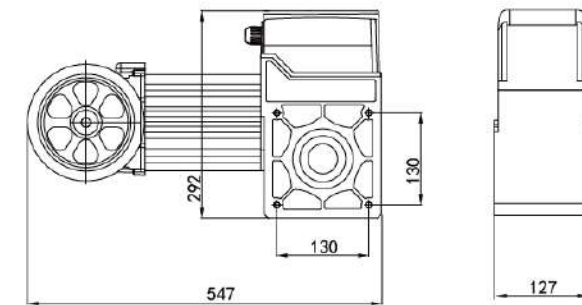

- ① Door opening button
- ② Door opening indicator
- ③ Stop button
- ④ Stop indicator
- ⑤ Door-closing button
- ⑥ Door-closing indicator
- ⑦ Power switch(optional)
- ⑧ Emergency stop button



■ Remote control



GYK-92S(380V)



■ Control box

■ Characteristics

- The man-machine interface, through digital display function, realizes the person and the equipment information exchange
- Can display running state of the door
- Can display the equipment failure code convenient maintenance
- With More than the limit protection function, prevent door overshoot
- With a door in door interlock protection function interface;
- With infrared, Pneumo Switch and other safety protection function interface,
- Can receive magnetism, entrance guard system, realizes the unmanned management, automatic open and close the doors;
- Can set shut down inching function, used for special occasions
- With single key cycle control function
- Collaborate with the encoder to directly set the travel limit of the door opener on the control panel

SECTIONAL Industrial Door Operator

(AC motor)

GYM Series (800N.m~1000N.m)

GYM(1500N.m~2000N.m) Series

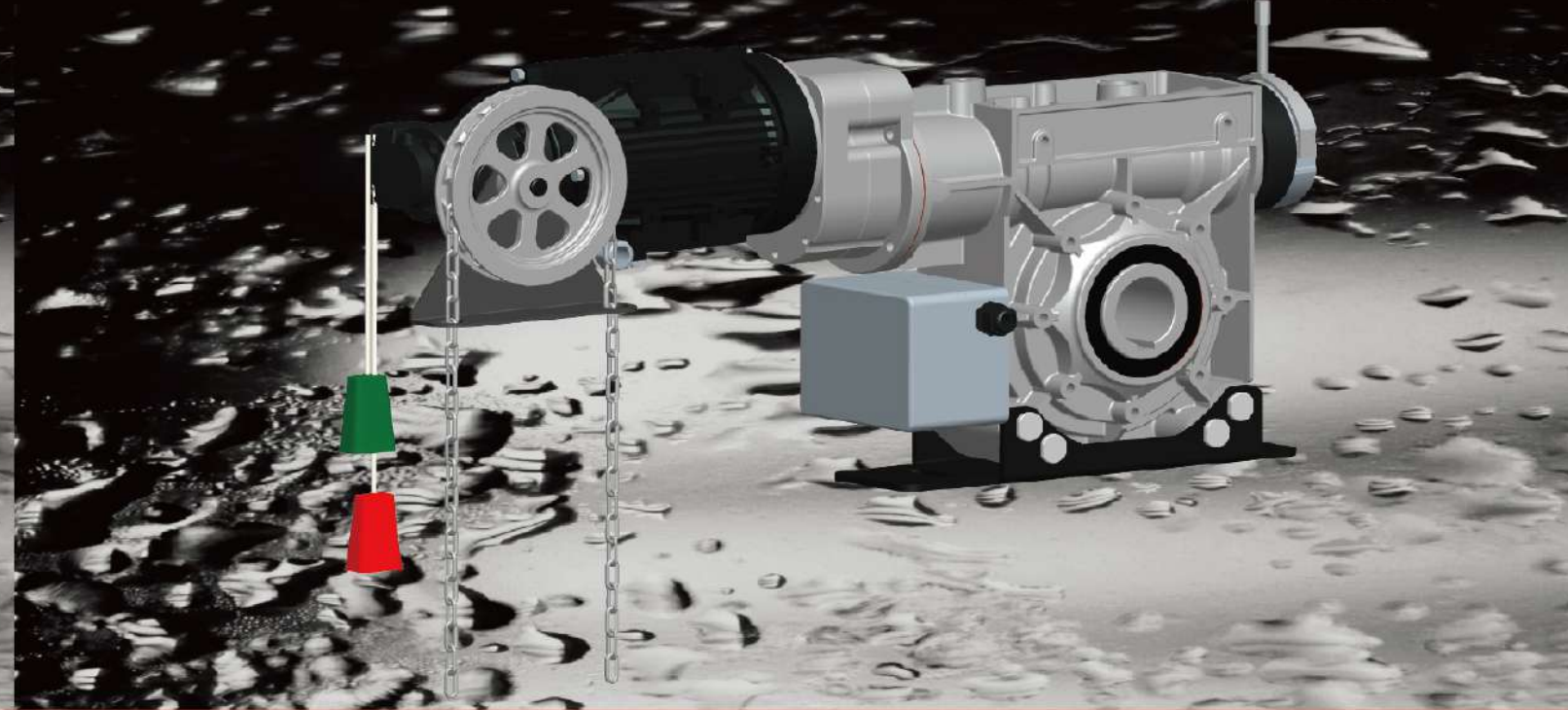
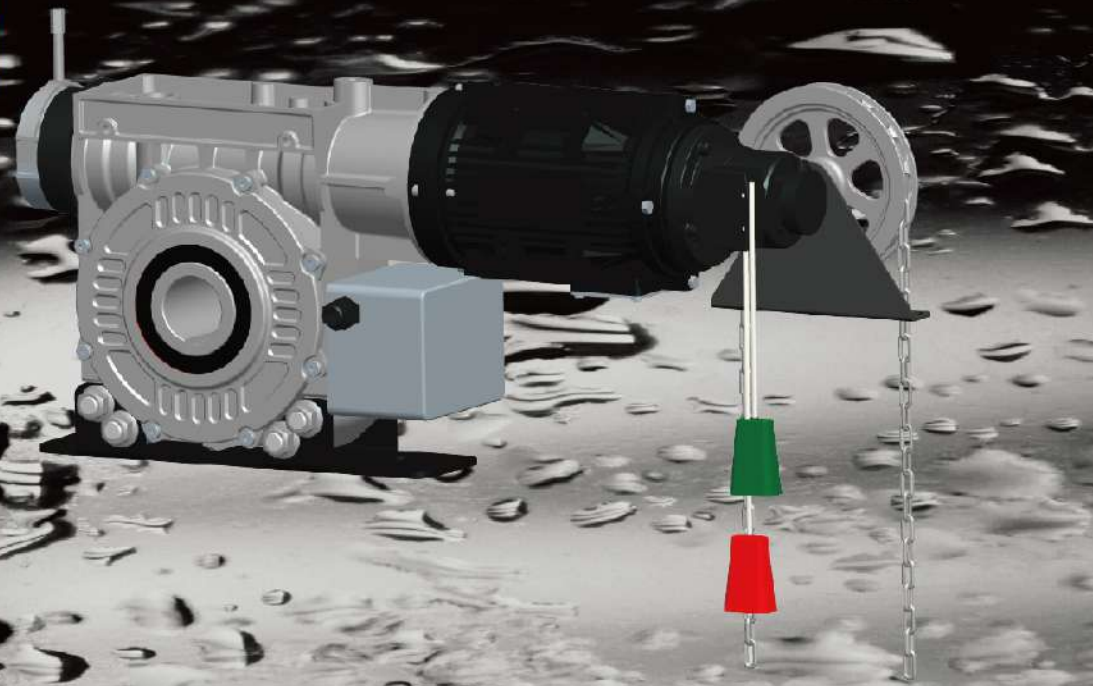

■ Performance Parameter

Model	GYM800S	GYM1000S	GYM1500S	GYM2000S
Output torque	800N.m	1000N.m	1500N.m	2000N.m
Locking torque	2800N.m	2800N.m	4500N.m	4500N.m
Output speed	15rpm	15rpm	7rpm	7rpm
Operational voltage	AC3*400V 50/60Hz			
Motor power	2.2KW	3.0KW	2.2KW	3.0KW
Motor type	AC motor			
Control voltage	24V			
Nominal motor current	5.1A	6.9A	5.1A	6.9A
Motor duty cycle	S3 60%			
Limit switch range	24 circle			
Limit mode	Mechanical limit / Electronic limit			
Output shaft	55mm/60mm			60mm
Runing Noise	< 70dB			
Temperature Range	(-40 ℃ ~ +85 ℃)			
Relative Humidity	< 90%			
Protection Level	IP54			
weight	45Kg	50Kg	55Kg	60Kg

■ Dimensions

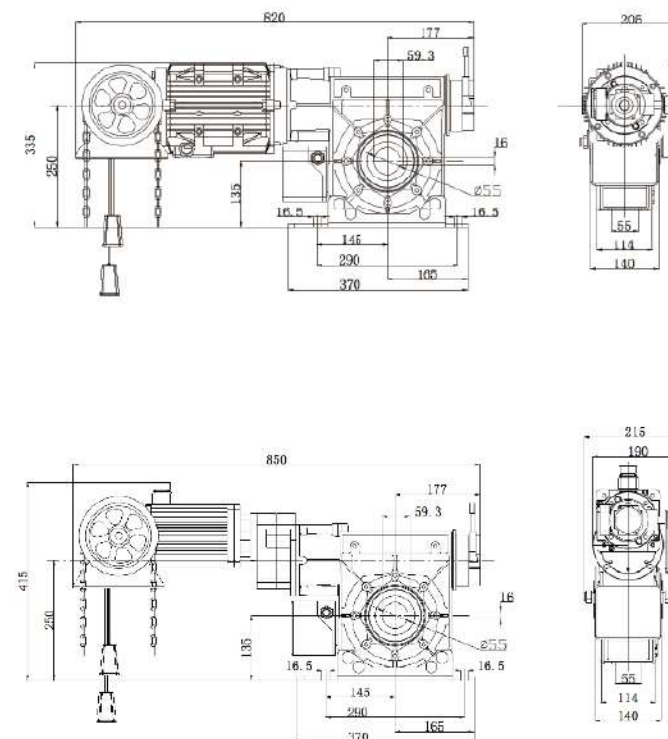

■ Remote control



GYK-92S(380V)



■ Control box

■ Characteristics

- The man-machine interface, through digital display function, realizes the person and the equipment information exchange
- Can display running state of the door
- Can display the equipment failure code convenient maintenance
- With More than the limit protection function, prevent door overshoot
- With a door in door interlock protection function interface;
- With infrared, Pneumo Switch and other safety protection function interface,
- Can receive magnetism, entrance guard system, realizes the unmanned management, automatic open and close the doors;
- Can set shut down inching function, used for special occasions
- With single key cycle control function
- Collaborate with the encoder to directly set the travel limit of the door opener on the control panel

SECTIONAL Industrial Door Operator (VFD Motor)

GYM-3 Series (40N.m~150N.m)



Slow Start
Slow Stop

Absolute
value encoder
journey limit

■ Selection Motor Performance & Configuration



■ Performance Parameter

Model	GYM40S-3	GYM60S-3	GYM100S-3	GYM150S-3
Input voltage	AC230V 50/60Hz	AC230V 50/60Hz	AC230V 50/60Hz	AC230V 50/60Hz
Rated power	370W	450W	650W	800W
Startup torque	40N.m	60N.m	100N.m	150N.m
No-load running time	25min	25min	25min	25min
Maximum door weight	15m ²	25m ²	30m ²	40m ²
Mode of supportive power-control	Split type			
Thermal protective temperature	120°C			
Retarding mechanism	Mechanism completely built with cooper worm wheels and worm rods			
No-load rotating speed	24r/min			
Lubrication	Oil submerging			
Noise	≤55dB			
Mode of manual chain	Universal chain style			
Operation mode	Standard			
Max. Limited journey	20 rounds rotation of the output shaft			
Type of limit switch	Electronic limit			
Diameters of the hole for output shaft	Φ25.4mm/Φ31.75mm			
Ambient temperature	-20°C ~ +45°C			
Working system	S2 20%			
Protective level	IP54			
Total weight	15KG	16KG	18KG	

■ Dimensions

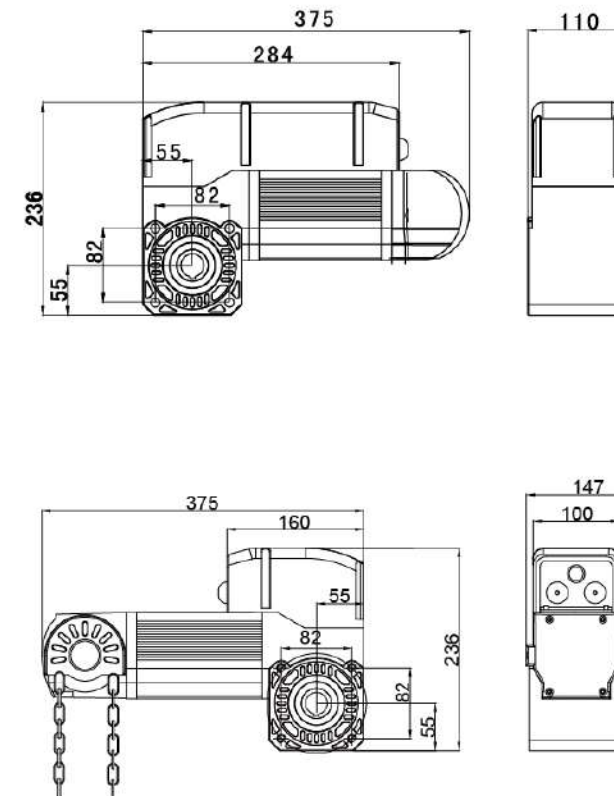

■ Characteristics

- The phase sequence automatic detection function, ensure the door moving in the right direction;
- With a door in door interlock protection function interface
- With infrared, Pneumo Switch and other safety protection function interface
- Can receive magnetism, entrance guard system, realizes the unmanned management, automatic open and close the doors;
- Can set shut down door inching function, used for special occasions.

SECTIONAL Industrial Door Operator (VFD Motor)

GYM Series (180N.m~400N.m)



**Slow Start
Slow Stop**

**Absolute
value encoder
journey limit**

■ Selection Motor Performance & Configuration

- Mechanical limit**
Double limit protection, more safe and reliable
- Electronic limit**
Lead to adopt high precision 14 absolute encoder (16000 pulse point) of electronic limit mechanism. A greater degree of improve the precision of limit.
- Semi-automatic manual chain mechanism**
(Max.hand force KNH 120N)
- Semi-automatic manual chain mechanism**
(Max.hand force KNH 245N)
- Anti-fall safeguard Safety brake systems**
inside reducer
- The reduction gearbox** adopts precision worm gear and worm drive and oil-immersed lubrication, smooth transmission, low noise, long service life;

■ Performance Parameter

Model	GYM200S-3	GYM350S-3	GYM500S-3					
Input Voltage	AC400V 50/60Hz	AC400V 50/60Hz	AC400V 50/60Hz					
Rated Power	1100W	1500W	1800W					
Startup Torque	180N.m	300N.m	400N.m					
No-load Running Time	25min	25min	25min					
No-load Rotating Speed	12~20r/min	12~20r/min	12~20r/min					
Rated current	4.5A	5.5A	6.5A					
Maximum Door Weight	50m'	70m'	100m'					
Mode of supportive power-control	Split type							
Thermal Protective Temperature	120°C							
Retarding Mechanism	Mechanism completely built with cooper worm wheels and worm rods							
Lubrication	Oil submerging							
Noise	≤60dB							
Mode of manual chain	Semi-automatic manual chain mechanism							
Max. Limited Journey	24 rounds rotation of the output shaft							
Type of limit switch	Mechanical limit	Electronic limit	Mechanical limit	Electronic limit	Mechanical limit	Electronic limit	Mechanical limit	Electronic limit
Diameters of the hole for output shaft	φ 25.4、φ 31.75、φ 40							
Ambient Temperature	-20°C~+45°C							
Working System	S2 20% / S3 60%							
Protective level	IP54							
Total weight	26Kg	28Kg	30Kg	32Kg				

■ Dimensions

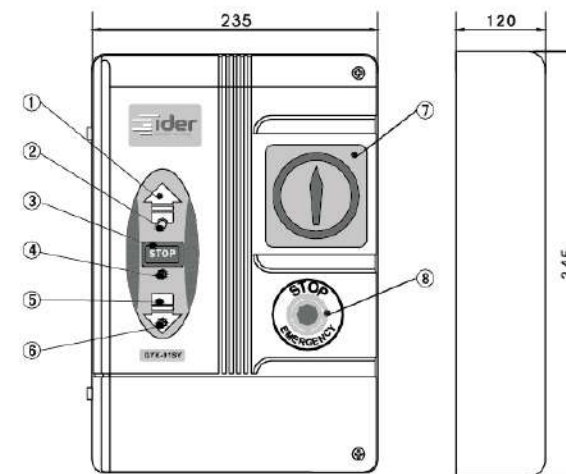
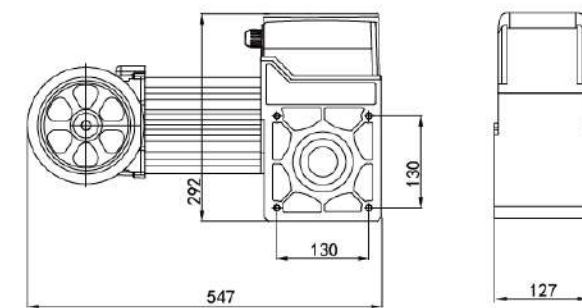

① Door opening button ② Door opening indicator ③ Stop button ④ Stop indicator
⑤ Door-closing button ⑥ Door-closing indicator ⑦ Power switch(optional) ⑧ Emergency stop button



■ Characteristics

- The phase sequence automatic detection function, ensure the door moving in the right direction;
- With a door in door interlock protection function interface
- With Infrared, Pneumo Switch and other safety protection function interface
- Can receive magnetism, entrance guard system, realizes the unmanned management, automatic open and close the doors;
- Can set shut down door inching function, used for special occasions.

SECTIONAL Industrial Door Operator (SERVO Motor)

GYM-SF Series (50N.m~200N.m)



Slow Start
Slow Stop

Absolute
value encoder
journey limit

■ Selection Motor Performance & Configuration

Electronic limit
Lead to adopt high precision 17 absolute encoder (16000 pulse point) of electronic limit mechanism. A greater degree of improve the precision of limit.

Universal manual chain release when power off;

Continuously Variable Transmission, soft start and slow stop, run more smoothly

Housing surface adopted powder coating processing, more beautiful and durable.

Semi-Auto Release

■ Performance Parameter

Model	GYM50SF	GYM80SF	GYM120SF	GYM200SF
Input Voltage	AC220V	AC220V	AC220V	AC220V
Rated Power	500W	750W	1500W	2000W
Startup Torque	50N.m	80N.m	120N.m	200N.m
No-load Running Time	25min			
Maximum Door Weight	20m ²	30m ²	40m ²	60m ²
Mode of supportive power-control	Integrations			
Reduction Mechanism	Mechanism completely built with cooper worm wheels and worm rods			
No-load Rotating Speed	22r/min~32r/min			
Lubrication	Oil-immersed			
Noise	≤55dB			
Mode of manual chain	Universal chain style			
Max. Limited Journey	30m			
Type of limit switch	Electronic limit			
Diameters of the hole for output shaft	Φ25.4			
mbient Temperature	-20 C~+45 C			
Working System	S3 60%			
Protective level	IP54			
Total Weight	10Kg	12Kg	15Kg	18Kg

■ Dimensions

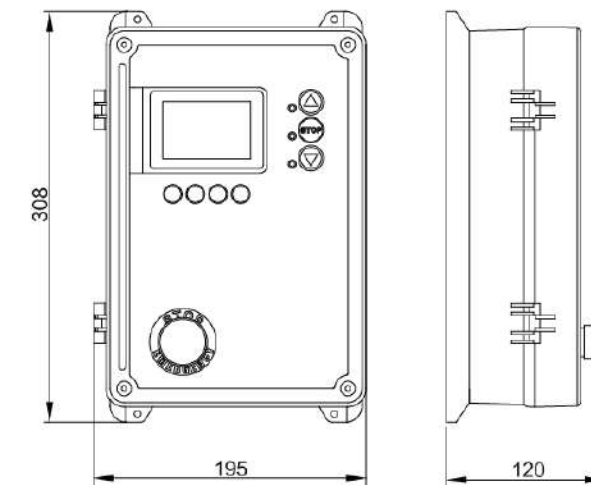
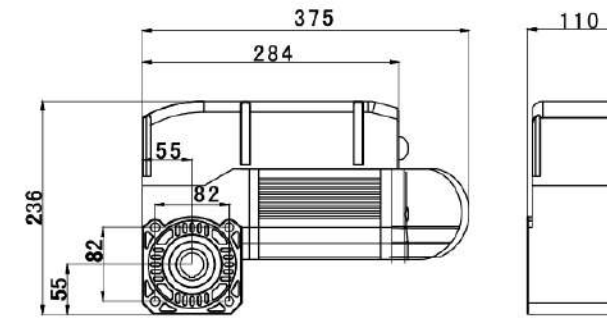

■ Control box



■ Remote control

■ Characteristics

- LCD display, Chinese and English operation interface, more convenient for debugging;
- Has a slow start and stop function, with adjustable door opening and closing speed;
- There are three multi-functional signal output ports that can provide position signals for three sets of doors to other devices,
- To achieve linkage or interlocking;
- Fault prompts in Chinese (English) for easy remote guidance and quick troubleshooting;
- Equipped with safety interfaces such as infrared and airbags;
- Multiple methods such as buttons, remote control, radar, etc. can be used to open and close doors;
- With maintenance prompt function, maintenance interval can be set;

SECTIONAL Industrial Door Operator (SERVO Motor)

GYM-SF Series (300N.m~800N.m)



Slow Start
Slow Stop

Absolute
value encoder
journey limit

GYM-SF Series (1000N.m~2000N.m)



Slow Start
Slow Stop

Absolute
value encoder
journey limit

■ Performance Parameter

Model	GYM300SF	GYM500SF	GYM800SF	GYM1000SF	GYM1500SF	GYM2000SF
Input Voltage	AC230V 50/60Hz					
Rated Power	800W	1500W	2200W	3000W	2200W	3000W
Startup Torque	300N.m	500N.m	800N.m	1000N.m	1500N.m	2000N.m
No-load Running Time	25min	25min	25min	25min	25min	25min
No-load Rotating Speed	12~20r/min	12~20r/min	15~22r/min	15~22r/min	7~15r/min	7~15r/min
Rated current	4.5A	6.5A	8.5A	11.5A	8.5A	11.5A
Maximum Door Weight	80m ²	100m ²	120m ²	150m ²	180m ²	200m ²
Mode of supportive power-control	Split type					
Thermal Protective Temperature	120°C					
Retarding Mechanism	Mechanism completely built with cooper worm wheels and worm rods					
Lubrication	Oil submerging					
Noise	≤60dB					
Mode of manual chain	Semi-automatic manual chain mechanism					
Max. Limited Journey	30m					
Type of limit switch	Electronic limit					
Diameters of the hole for output shaft	φ40mm		φ55mm		φ60mm	
Ambient Temperature	-20°C~+45°C					
Working System	S3 60%					
Protective level	IP54					
Total weight	26Kg	28Kg	35Kg	40Kg	45Kg	50Kg

■ Dimensions

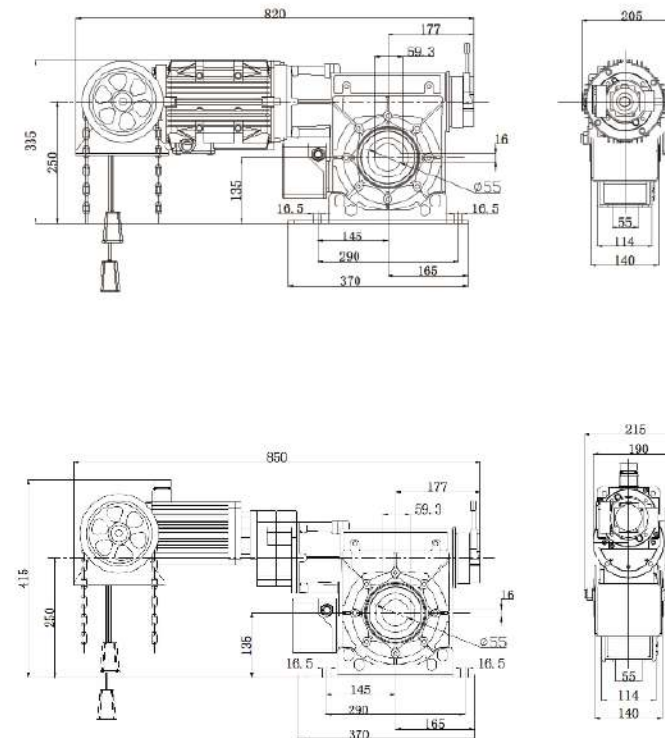

■ Control box



■ Remote control

■ Characteristics

- LCD display, Chinese and English operation interface, more convenient for debugging;
- Has a slow start and stop function, with adjustable door opening and closing speed;
- There are three multi-functional signal output ports that can provide position signals for three sets of doors to other devices,
- To achieve linkage or interlocking;
- Fault prompts in Chinese (English) for easy remote guidance and quick troubleshooting;
- Equipped with safety interfaces such as infrared and airbags;
- Multiple methods such as buttons, remote control, radar, etc. can be used to open and close doors;
- With maintenance prompt function, maintenance interval can be set;

SECTIONAL Industrial Door Operator

(DC24V SERVO Motor)

GYM-SFL Series (30N.m~120N.m)



Slow Start
Slow Stop

Absolute
value encoder
journey limit

■ Selection Motor Performance & Configuration

Electronic limit
Lead to adopt high precision 17
absolute encoder (16000 pulse
point) of electronic limit
mechanism. A greater degree of
improve the precision of limit.

Universal manual chain release
when power off;

Continuously Variable Transmission,
soft start and slow stop, run more smoothly

Housing surface adopted powder
coating processing, more beautiful
and durable.

Semi-Auto Release

■ Performance Parameter

Model	GYM30SFL	GYM50SFL	GYM80SFL	GYM120SFL
Input Voltage	AC220V	AC220V	AC220V	AC220V
Motor Voltage	DC24V	DC24V	DC36V	DC36V
Rated Power	150W	250W	300W	500W
Startup Torque	30N.m	50N.m	80N.m	120N.m
No-load Running Time	25min			
Maximum Door Weight	20m ²	30m ²	40m ²	60m ²
No-load Rotating Speed	22r/min~32r/min			
Lubrication	Oil-immersed			
Noise	≤55dB			
Mode of manual chain	Universal chain style			
Max. Limited Journey	30m			
Type of limit switch	Electronic limit			
Diameters of the hole for output shaft	Φ25.4			
mbient Temperature	-20℃~+45℃			
Working System	S3 60%			
Protective level	IP54			
Total Weight	12Kg	15Kg	15Kg	18Kg

■ Dimensions

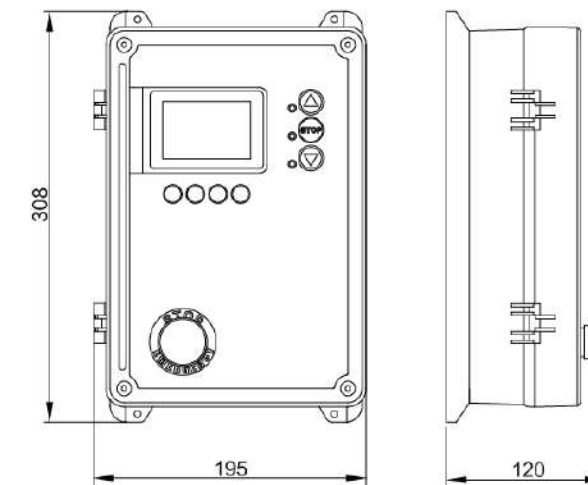
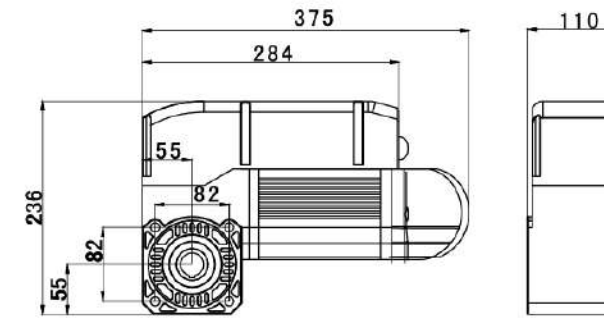

■ Control box



■ Remote control

■ Characteristics

- LCD display, Chinese and English operation interface, more convenient for debugging;
- Has a slow start and stop function, with adjustable door opening and closing speed;
- There are three multi-functional signal output ports that can provide position signals for three sets of doors to other devices,
- To achieve linkage or interlocking;
- Fault prompts in Chinese (English) for easy remote guidance and quick troubleshooting;
- Equipped with safety interfaces such as infrared and airbags;
- Multiple methods such as buttons, remote control, radar, etc. can be used to open and close doors;
- With maintenance prompt function, maintenance interval can be set;

ROLLER SHUTTER Door Operator

(AC motor)

GYM Series (200N.m~650N.m)

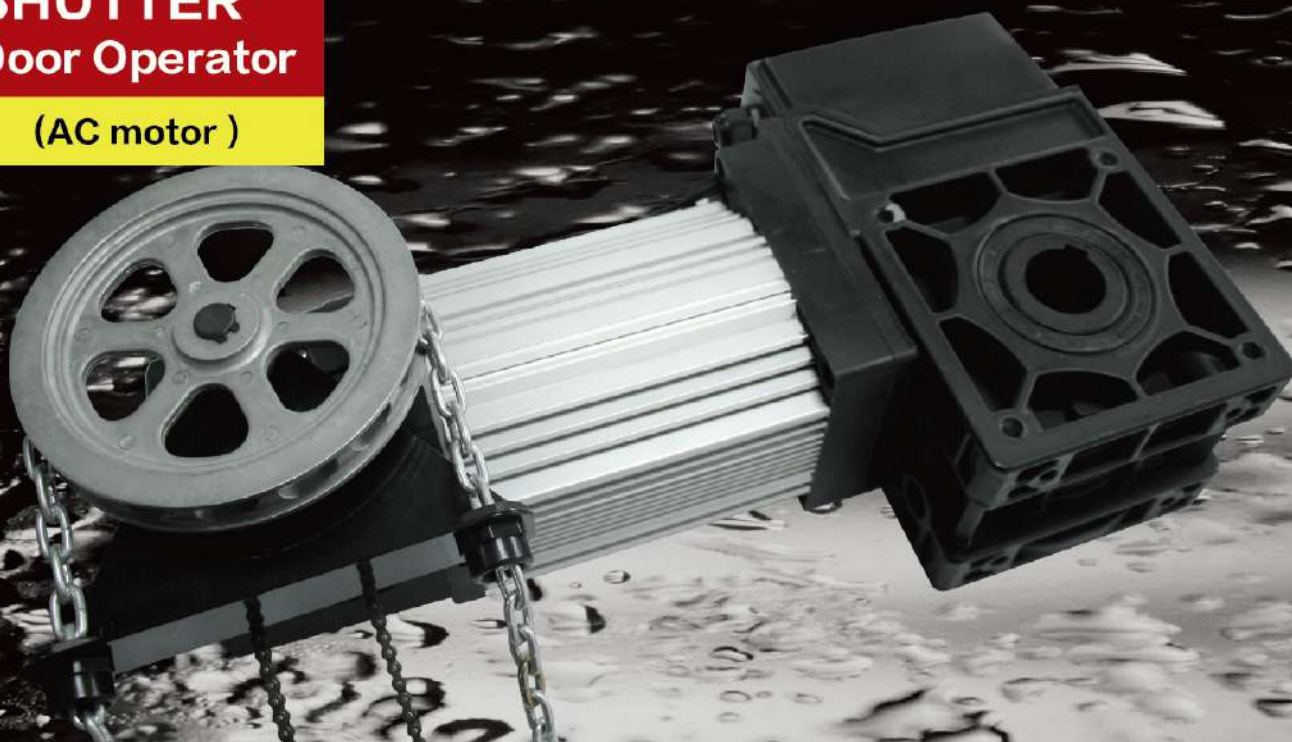

■ Selection Motor Performance & Configuration

- Mechanical limit**
Double limit protection, more safe and reliable
- Electronic limit**
Lead to adopt high precision 14 absolute encoder (16000 pulse point) of electronic limit mechanism. A greater degree of improve the precision of limit.
- Semi-automatic manual chain mechanism**
(Max.hand force KNH 120N)
- Semi-automatic manual chain mechanism**
(Max.hand force KNH 245N)
- Anti-fall safeguard Safety brake systems** inside reducer
- The reduction gearbox adopts precision worm gear and worm drive and oil-immersed lubrication, smooth transmission, low noise, long service life;

■ Performance Parameter

Model	GYM200S	GYM260S	GYM350S	GYM500S	GYM650S			
Input Voltage	AC400V 50/60Hz	AC400V 50/60Hz	AC400V 50/60Hz	AC400V 50/60Hz	AC400V 50/60Hz			
Rated Power	800W	800W	1000W	1200W	1500W			
Startup Torque	200N.m	260N.m	350N.m	500N.m	650N.m			
No-load Running Time	25min	25min	25min	25min	25min			
No-load Rotating Speed	22r/min	12r/min	12r/min	12r/min	8r/min			
Rated current	3.5A	3.5A	3.5A	3.5A	4.5A			
Max.Door Weight (140mm)	285Kg	370Kg	500Kg	710Kg	920Kg			
Max.Door Weight (200mm)	200Kg	260Kg	350Kg	500Kg	650Kg			
Thermal Protective Temperature	120°C							
Retarding Mechanism	Mechanism completely built with cooper worm wheels and worm rods							
Lubrication	Oil submerging							
Noise	≤60dB							
Mode of manual chain	Semi-automatic manual chain mechanism							
Max. Limited Journey	24 rounds rotation of the output shaft (Optional 60 rounds)							
Type of limit switch	Mechanical limit	Electronic limit	Mechanical limit	Electronic limit	Mechanical limit	Electronic limit	Mechanical limit	Electronic limit
Diameters of the hole for output shaft	φ 25.4、φ 31.75、φ 40							
Ambient Temperature	-20°C~+45°C							
Working System	S2 20% / S3 60%							
Protective level	IP54							
Total weight	26Kg	28Kg	30Kg	30Kg	32Kg			

■ Dimensions

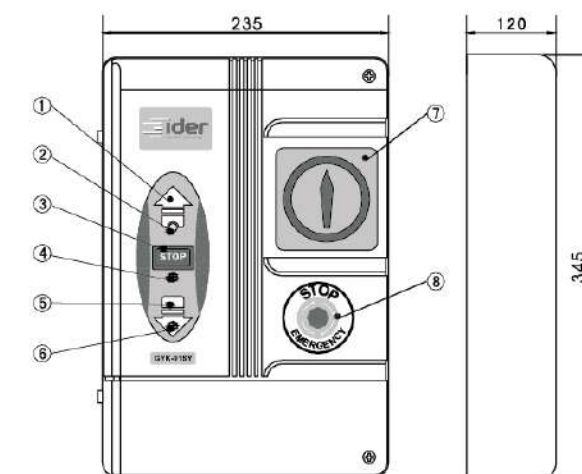
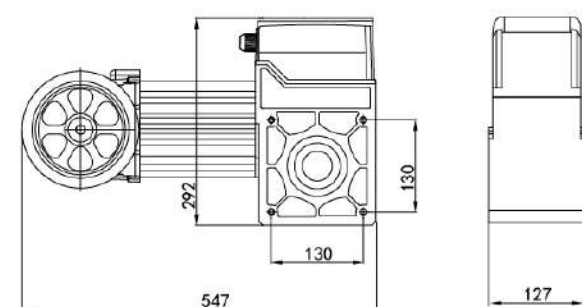

- ① Door opening button ② Door opening indicator ③ Stop button ④ Stop indicator
- ⑤ Door-closing button ⑥ Door-closing Indicator ⑦ Power switch(optional) ⑧ Emergency stop button

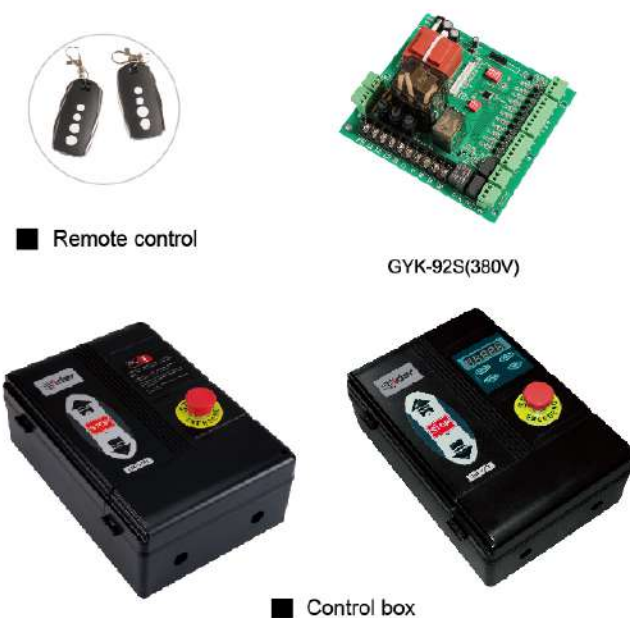

■ Characteristics

- The man-machine interface, through digital display function, realizes the person and the equipment information exchange
- Can display running state of the door
- Can display the equipment failure code convenient maintenance
- With More than the limit protection function, prevent door overshoot
- With a door in door interlock protection function interface;
- With infrared, Pneumo Switch and other safety protection function interface,
- Can receive magnetism, entrance guard system, realizes the unmanned management, automatic open and close the doors;
- Can set shut down inching function, used for special occasions
- With single key cycle control function
- Collaborate with the encoder to directly set the travel limit of the door opener on the control panel

ROLLER SHUTTER Door Operator

(AC motor)

GYM Series (800N.m~1000N.m)

GYM(1500N.m~2000N.m) Series

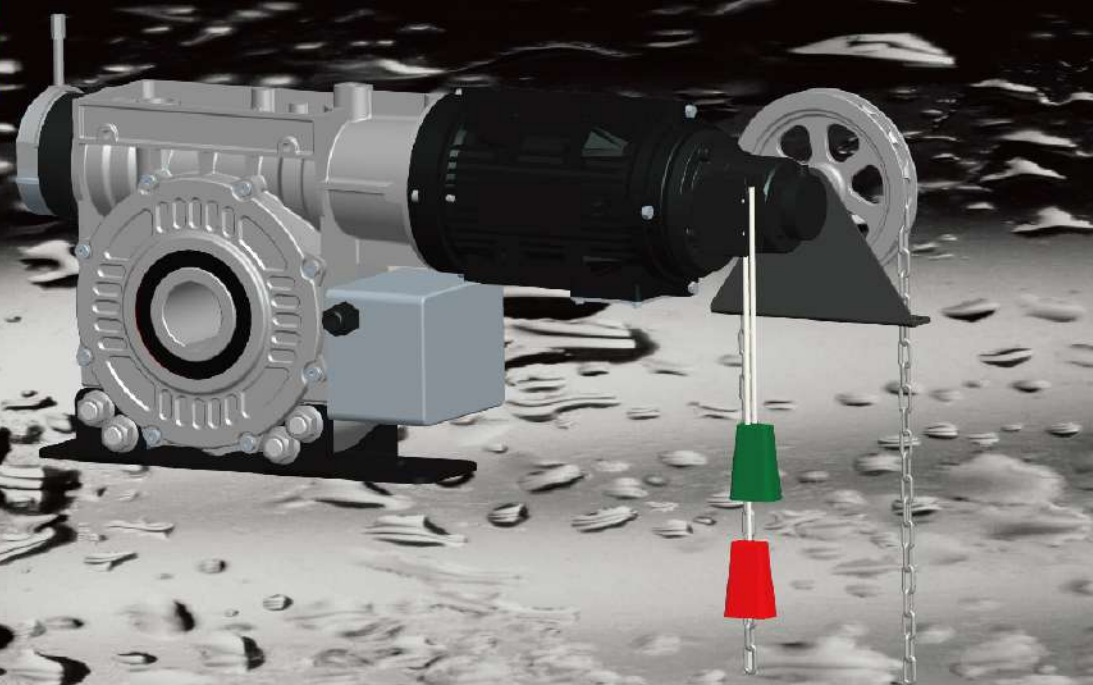

Performance Parameter

Model	GYM800S	GYM1000S	GYM1500S	GYM2000S
Output torque	800N.m	1000N.m	1500N.m	2000N.m
Locking torque	2800N.m	2800N.m	4500N.m	4500N.m
Max.Door Weight (160mm)	1000Kg	1250Kg	1875Kg	2500Kg
Max.Door Weight (200mm)	800Kg	1000Kg	1500Kg	2000Kg
Output speed	15rpm	15rpm	7rpm	7rpm
Operational voltage	AC3*400V 50/60Hz			
Motor power	2.2KW	3.0KW	2.2KW	3.0KW
Motor type	AC motor			
Control voltage	24V			
Nominal motor current	5.1A	6.9A	5.1A	6.9A
Motor duty cycle	S3 60%			
Limit switch range	24 circle			
Limit mode	Mechanical limit / Electronic limit			
Output shaft	55mm/60mm		60mm	
Runing Noise	< 70dB			
Temperature Range	(-40℃ ~ +85℃)			
Relative Humidity	< 90%			
Protection Level	IP54			
weight	45Kg	50Kg	55Kg	60Kg

Dimensions

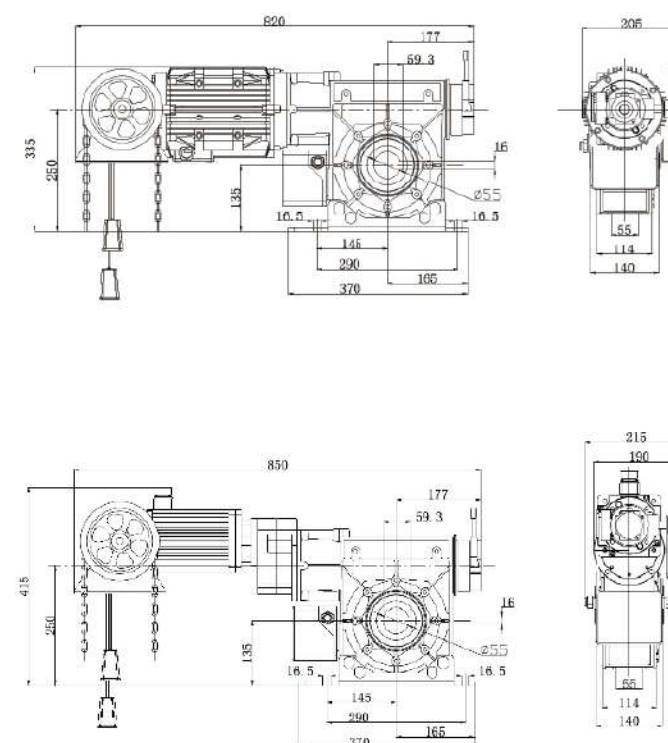

Remote control



GYK-92S(380V)



Control box

Characteristics

- The man-machine interface, through digital display function, realizes the person and the equipment information exchange
- Can display running state of the door
- Can display the equipment failure code convenient maintenance
- With More than the limit protection function, prevent door overshoot
- With a door in door interlock protection function interface;
- With infrared, Pneumo Switch and other safety protection function interface,
- Can receive magnetism, entrance guard system, realizes the unmanned management, automatic open and close the doors;
- Can set shut down inching function, used for special occasions
- With single key cycle control function
- Collaborate with the encoder to directly set the travel limit of the door opener on the control panel

ROLLER SHUTTER Door Operator

(SERVO Motor)

GYM-SF Series (300N.m~1000N.m)

GYM-SF Series (1500N.m~2000N.m)

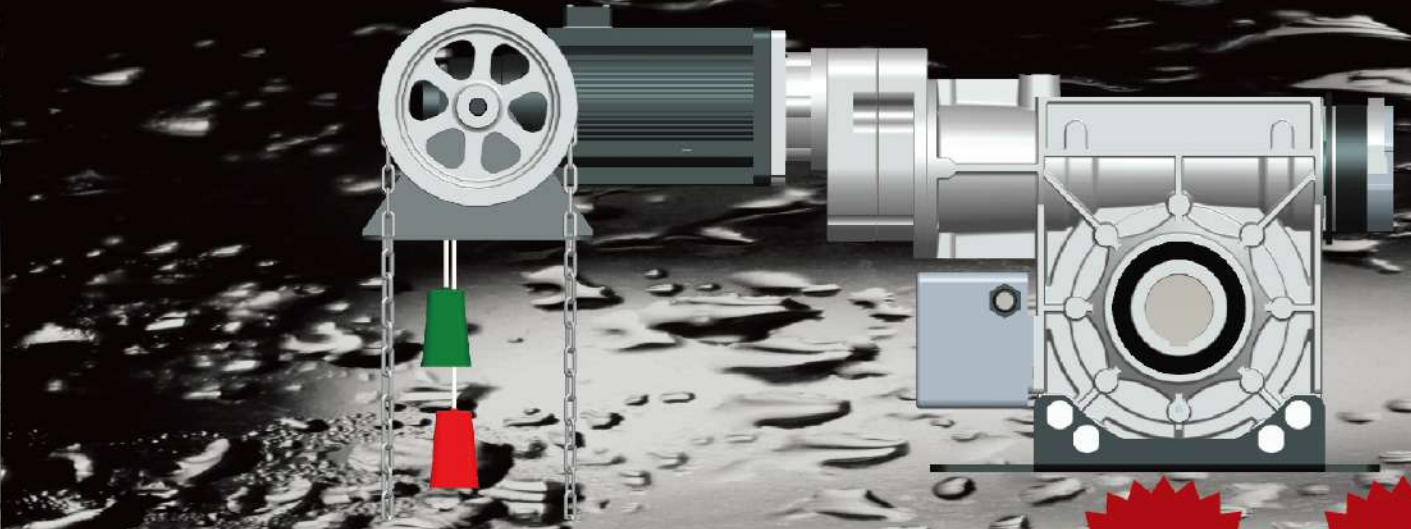

Slow Start
Slow Stop

Absolute
value encoder
journey limit

Slow Start
Slow Stop

Absolute
value encoder
journey limit

Performance Parameter

Model	GYM300SF	GYM500SF	GYM800SF	GYM1000SF	GYM1500SF	GYM2000SF
Input Voltage	AC230V 50/60Hz					
Rated Power	800W	1500W	2200W	3000W	2200W	3000W
Startup Torque	300N.m	500N.m	800N.m	1000N.m	1500N.m	2000N.m
Max.Door Weight (160mm)	370Kg	620Kg	1000Kg	1250Kg	1870Kg	2500Kg
Max.Door Weight (200mm)	300Kg	500Kg	800Kg	1000Kg	1500Kg	2000Kg
No-load Running Time	25min	25min	25min	25min	25min	25min
No-load Rotating Speed	12~20r/min	12~20r/min	15~22r/min	15~22r/min	7~15r/min	7~15r/min
Rated current	4.5A	6.5A	8.5A	11.5A	8.5A	11.5A
Thermal Protective Temperature	120°C					
Retarding Mechanism	Mechanism completely built with cooper worm wheels and worm rods					
Lubrication	Oil submerging					
Noise	≤60dB					
Mode of manual chain	Semi-automatic manual chain mechanism					
Max. Limited Journey	30m					
Type of limit switch	Electronic limit					
Diameters of the hole for output shaft	φ40mm	φ55mm			φ60mm	
Ambient Temperature	-20°C~+45°C					
Working System	S3 60%					
Protective level	IP54					
Total weight	26Kg	28Kg	35Kg	40Kg	45Kg	50Kg

Dimensions

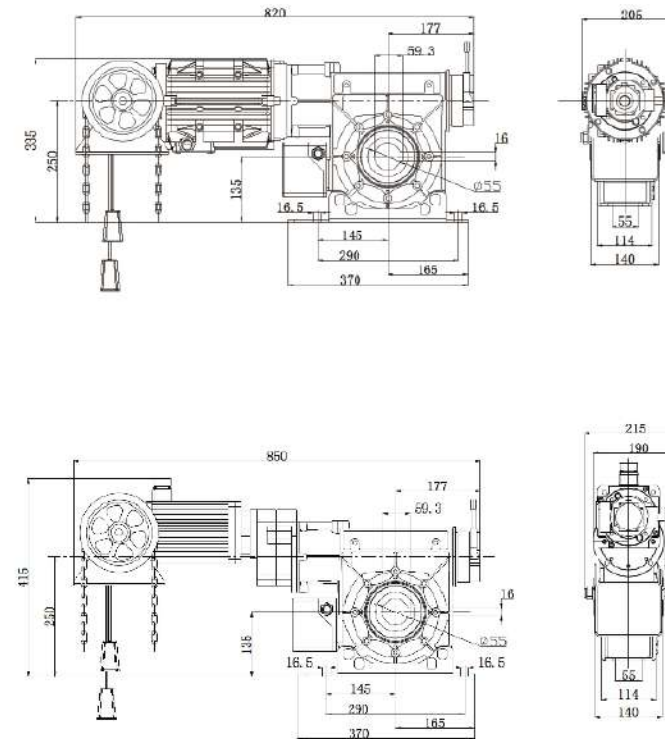

Control box



Remote control

Characteristics

- LCD display, Chinese and English operation interface, more convenient for debugging;
- Has a slow start and stop function, with adjustable door opening and closing speed;
- There are three multi-functional signal output ports that can provide position signals for three sets of doors to other devices.
- To achieve linkage or interlocking;
- Fault prompts in Chinese (English) for easy remote guidance and quick troubleshooting;
- Equipped with safety interfaces such as infrared and airbags;
- Multiple methods such as buttons, remote control, radar, etc. can be used to open and close doors;
- With maintenance prompt function, maintenance interval can be set;

SLIDING Industrial Door Operator (AC Motor)

GYT Series (800Kg~2500Kg)



Back Quick Release

Front Quick Release



Split Type Control



Integrated Type Control

GYT Advantage

- The reduction gearbox adopts precision worm gear and worm drive and oil-immersed
- Lubrication, smooth transmission low noise, long service life
- Built-in limit, the structure is more compact more convenient adjustment
- Unique quick release mechanism convenient operate door in an emergency
- According to different structure can choose the on load bearing or down bearing installation;
- Can choose according to need to use split type electric control or all-in-one control;
- Control box with infrared, PNEUMO Switch and so on the many kinds of protection terminal interface;
- Fast Rolling Door-operators for Industrial Purposes:

Performance Parameter

Model	GYT50	GYT70	GYT60S	GYT100S	GYT150S
Input Voltage	AC220V	AC220V	AC380V	AC380V	AC380V
Rated Power	300W	500W	300W	450W	650W
Startup Torque	35N.m	60N.m	60N.m	100N.m	150N.m
No-load Running Time	15min	15min	25min	25min	25min
Maximum Door Weight	800kg	1200kg	1200kg	2000kg	2500kg
Diameters of the hole for output shaft	Φ25.4mm				
Retarding Mechanism	Mechanism completely built with cooper worm wheels and worm rods				
No-load Rotating Speed	24r/min				
Lubrication	Oil submerging				
Thermal Protective Temperature	120°C				
Max. Limited Journey	20 rounds rotation of the output shaft				
Ambient Temperature	-20°C~+45°C				
Working System	S2 20%				
Noise	≤55dB				
Protective level	IP 54				
Mode of supportive power-control	Split type				
Mode of manual chain	Universal chain style				
Operation mode	Standard				
Type of limit switch	Electronic limit				
Total weight	13kg	14kg	13kg	14kg	15kg

Dimensions

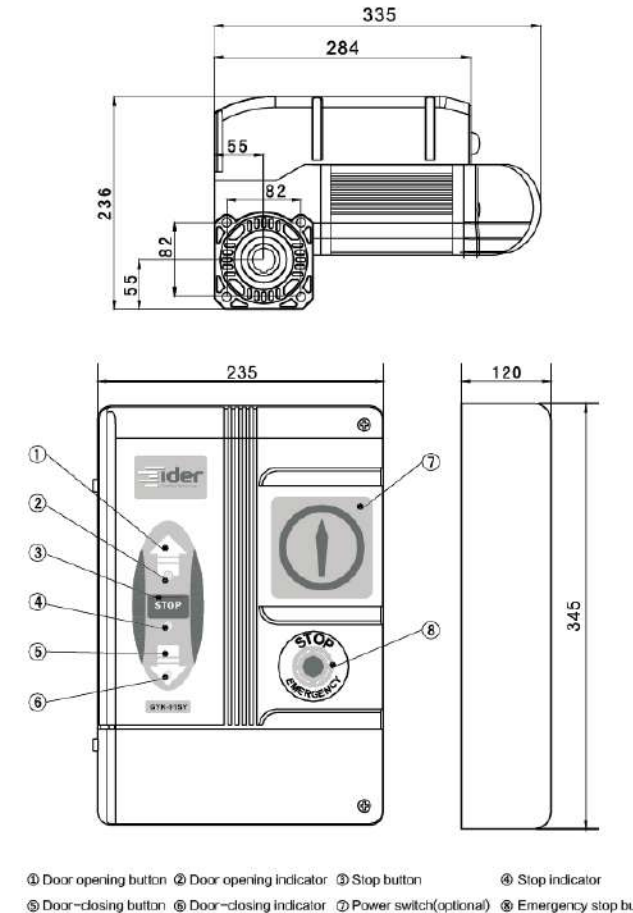

Installation Diagram

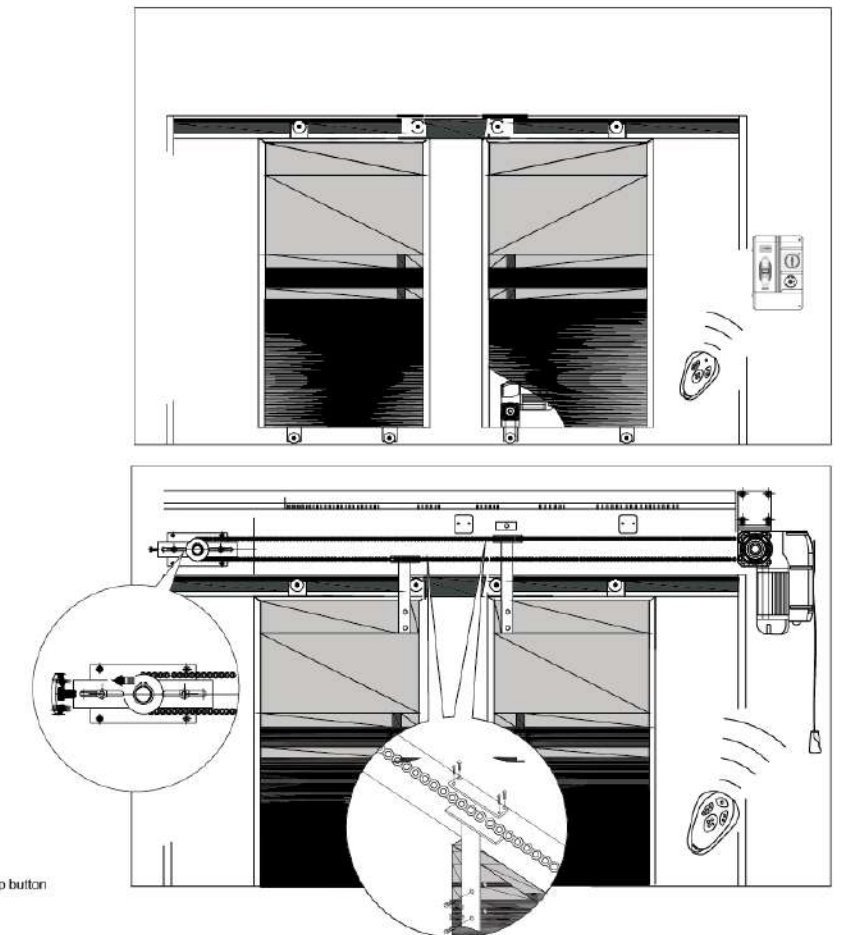

EXPLOSION Proof Door Operator (AC Motor)

GYF Series



Explosion proof Door Operator

Explosion-proof mark: Ex DIIb T4 Gb

- With flame-proof function, is suitable for explosive gas containing special occasions;
- Compact structure, powerful starting torque, stable operation;
- The absolute value encoder and motor integrated design, limit
- high accuracy, and can be directly at the door on the control panel to adjust the schedule, installation and debugging more convenient; The unique design of universal manual chain can adapt to different installation requirements;



Performance Parameter

Model	GYF100	GYF100
Input Voltage	AC380	AC220
Rated Power	800W	800W
Startup Torque	100N.m	100N.m
No-load Running Time	25min	15min
Maximum Door Weight	35m ²	35m ²
Thermal Protective Temperature	120°C	
Reduction Mechanism	Mechanism completely built with cooper worm wheels and worm rods	
No-load Rotating Speed	24r/min	
Lubrication	Oil submerging	
Noise	≤55dB	
Mode of manual chain	Universal chain style	
Max. Limited Journey	20 rounds rotation of the output shaft	
Type of limit switch	Electronic limit	
Diameters of the hole for output shaft	Φ25.4mm	
Ambient Temperature	-20°C ~ +45°C	
Working System	S2 20%	
Protective level	IP54	
Total Weight	33Kg	32Kg

Dimensions

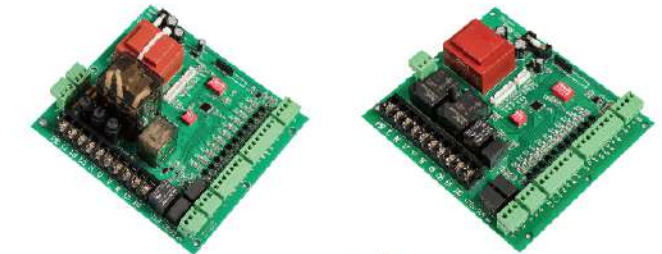
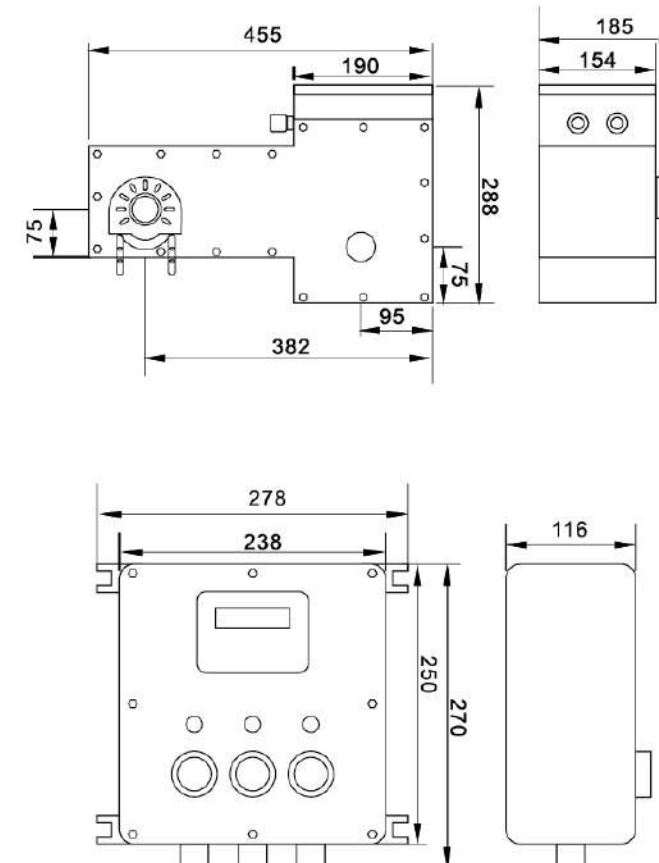

GYF100

Characteristics

- The man-machine interface, through digital display function, realizes the person and the equipment information exchange;
- Can display running state of the door;
- Can display the running time, and can be set up effective use of time;
- Can display the equipment failure code, convenient maintenance;
- With More than the limit protection function, prevent door overshoot;
- With a door in door interlock protection function;
- With infrared, Pneumo Switch protection function interface;
- May meet geomagnetic, entrance guard system, realizes the unmanned management, automatic doors;
- With opening and closing point move functions, Continuous movement functions, and each switch function;
- With step and step control functions; Can cooperate with encoder, directly on the control panel set limit to the operator.

HIGH SPEED Door Operator

(VFD Motor)



■ GYJ Advantage

the absolute value encoder and motor integrated design, limit, high accuracy more convenient installation and adjusting

quick release handle, convenient for open and close door in an emergency;

Housing surface coating processing more beautiful, durable.

The reduction gearbox adopts precision worm gear and worm drive and oil-immersed lubrication, smooth transmission, low noise, long service life;

Housing surface adopted powder coating processing, more beautiful and durable.

Semi-automatic manual chain mechanism (Max. hand force KNH 120N)



■ Performance Parameter

Model	GYJ40	GYJ60	GYJ50	GYJ80	GYJ70	GYJ100	GYJ150
Input Voltage	220V/ 50Hz	220V/ 50Hz	220V/ 50Hz	220V/ 50Hz	220V/ 50Hz	220V/ 50Hz	380V/50Hz
Rated Power	800W	800W	1000W	1000W	1500W	1500W	2200W
Startup Torque	40N.m	60N.m	50N.m	80N.m	70N.m	100N.m	150N.m
No-load Running Time	135r/min	90r/min	135r/min	90r/min	135r/min	90r/min	90r/min
Reduction Ratio	1:10	1:15	1:10	1:15	1:10	1:15	1:15
Door Size	12m ²	15m ²	15m ²	18m ²	20m ²	25m ²	30m ²
Supportive Power-control	GYK-93S-2						
Diameters of the hole for output shaft	Φ25mm						
Retarding Mechanism	Mechanism completely built with cooper worm wheels and worm rods						
Lubrication	Oil submerging						
Thermal Protective Temperature	120°C						
Max. Limited Journey	18 rounds rotation of the output shaft						
Ambient Temperature	-20°C~+45°C						
Working System	S2-20min/ S3-80%						
Noise	≤58dB						
Protective level	IP 54						
Maximum door weight	25m ²						
Mode of supportive power-control	Split type						
Mode of manual chain	Universal chain style						
Swift release upon power failure	Pull-rope release(optional)						
Type of limit switch	Absolute encoder of electronic limit Mechanism						
Total weight	20kg	20kg	22kg	22kg	25kg	25kg	30kg



GYK-93S-2



Circuit board



GYJ70/GYJ100

■ Dimensions

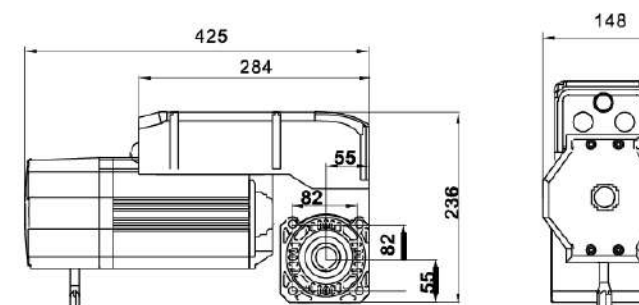

■ Characteristics

- The man-machine interface, through digital display function, realizes the person and the equipment information exchange;
- Can display running state of the door;
- Can display the running time, and can be set up effective use of time;
- Can display the equipment failure code convenient maintenance
- With More than the limit protection function, prevent door overshoot With a door in door interlock protection function;
- With infrared airbags protection function interface;
- May connection geomagnetic, entrance guard system, realizes the unmanned management, automatic open and close the doors;
- With opening and closing point move functions,Continuous movement functionsand each switch function; Single button mode;
- Can cooperate with encoder,directly on the control panel set limit to operator;
- With frequency conversion functioncan realize soft start and soft stop function.

HIGH SPEED Door Operator

(SERVO Motor)

GYJ-SF Series (550W~2200W)
PVC Door



GYW-SF Series (750W~2200W)
Spiral Door



Performance Parameter

Model	GYJ-SF-550	GYJ-SF-750	GYJ-SF-1500	GYJ-SF-2200	GYW-SF-750	GYW-SF-1500	GYW-SF-2200
Power Supply	AC230V 50/60Hz						
Rated Power	550W	750W	1500W	2200W	750W	1500W	2200W
Motor Torque	2.4N.m	3.6N.m	7.2N.m	15N.m	3.6N.m	7.2N.m	15N.m
Contoller	GYK-56SF-5	GYK-93SF-5	GYK-93SF-6	GYK-93SF-9	GYK-93SF-5	GYK-93SF-6	GYK-93SF-9
Motor speed	3000r/min	2500r/min	2000r/min	1500r/min	2500r/min	2000r/min	1500r/min
Reduction type	Copper worm gear worm wheel reducer				Planetary Gear		
Reducer ratio	1:25	1:10/1:15/1:20	1:15/1:20	1:20/1:40	1:10/1:15/1:20	1:15/1:20	1:20/1:30
Lubrication	Oil immersed						
Unload Noisy	≤58dB						
Limit Type	Electronic Limit with Absolute value encoder						
Door model	PVC Door				Spiral Door		
Shaft Dia.	25mm		28mm		25mm		30mm
Temperature	-20°C~+45°C						
IP Rating	IP54						

Dimensions

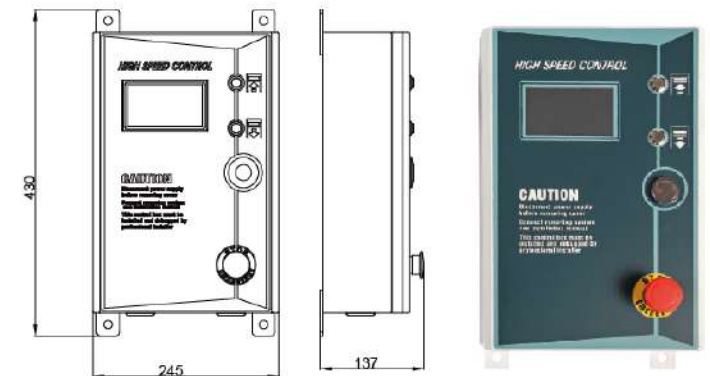
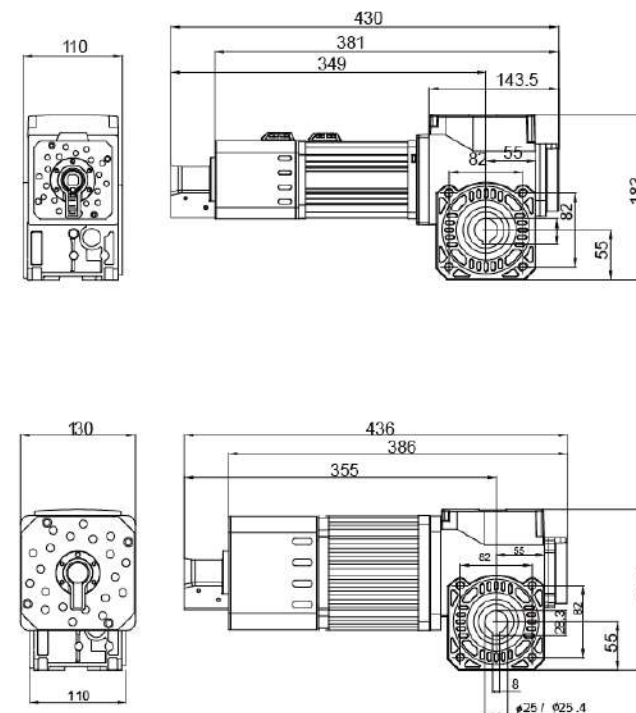

Control box

Characteristics

- LCD display, Chinese and English operation interface, debugging is more convenient;
- Open and Close the door by special metal button, better feel and more durable;
- Built-in electromagnetic brake system, accurate and stable operation of braking
- 62 Speed loop, Currency loop, Position loop by three-loop closed-loop control, more comprehensive protection, more accurate positioning;
- With slow start and slow stop function, the speed of opening and closing doors is adjustable;
- With 485 communication interface, it can be used with computers and other external safety devices;
- There are three multi-function signal output ports, which can provide three sets of door position signals to other devices to achieve linkage or interlocking;
- Trouble-Shooting in Chinese (English), convenient for remote guidance, rapid troubleshooting; With infrared, Pneumo Switch and other safety interfaces;
- The door can be opened and closed by buttons, remote control, radar and other ways; With maintenance function, you can set the maintenance time

Control System Combination

GYK-91SY/GYK-91Y Control System Combination



GYK-91S(400V)



GYK-91(230V)



Remote control



Control box

GYK-92SY/GYK-92Y Control System Combination



GYK-92S(400V)



GYK-92(230V)



Remote control



Control box

GYK-93S-1/GYK-95S-1 Control System Combination



GYK-93(400V)



GYK-95(230V)



Remote control



Control box

GYK-54SY/GYK-54Y Control System Combination



GYK-52SY (400V)



GYK-52Y (230V)



Remote control



Control box

GYK-55SY/GYK-55Y Control System Combination



GYK-52SY (400V)



GYK-52Y (230V)



Remote control



Control box

GYK-56S-1 Control System Combination



GYK-53SY (230V)



Remote control



Control box

Control System Combination

GYK-51SY/GYK-51Y Control System Combination



GYK-52SY (400V)



GYK-52Y (230V)



Remote control



Control box

GYK-52SY/GYK-52Y Control System Combination



GYK-52SY (400V)



GYK-52Y (230V)



Remote control



Control box

GYK-53S-1 Control System Combination



GYK-53SY (230V)



Remote control



Control box

GYK-56SF Control System Combination



GYK-53SY (230V)



Remote control



Control box

GYK-93S-2/GYK-95S-2 Control System Combination



GYK-93(400V)



GYK-95(230V)



Remote control



Control box

GYK-93SF Control System Combination



GYK-93(400V)



GYK-95(230V)



Remote control



Control box



■ Dimensions

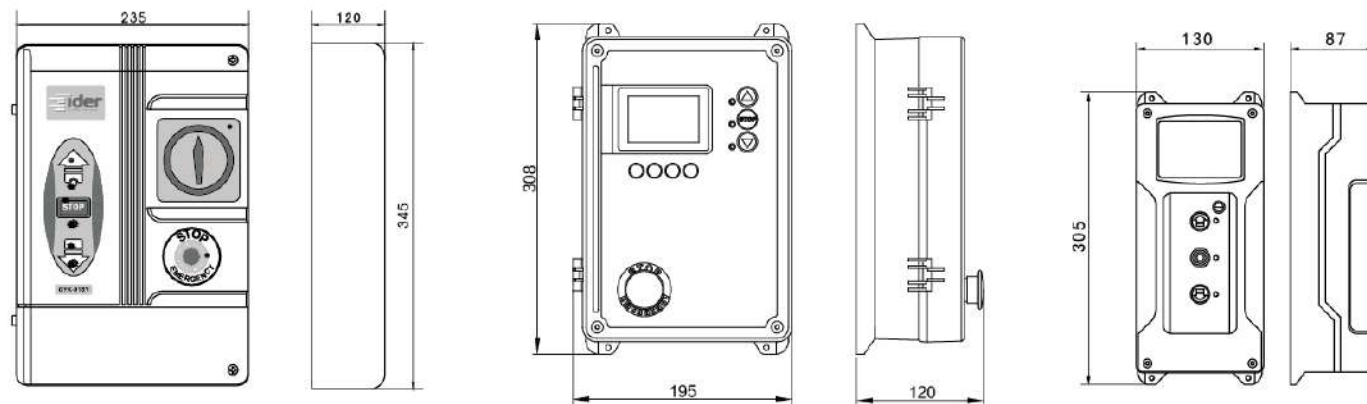

GYK-91
GYK-92
GYK-93
GYK-PT

GYK-54
GYK-55
GYK-56
GYK-PTS07

GYK-51
GYK-52
GYK-53

Control Model	Voltage	Motor Model	Limite Type
GYK-51Y	AC230V	GYM50~~~GYM100	Mechanical limit
GYK-51SY	AC400V	GYM40S~~~GYM2000S	Mechanical limit
GYK-52Y	AC230V	GYM50~~~GYM100	Electronic limit
GYK-52SY	AC400V	GYM40S~~~GYM2000S	Electronic limit
GYK-53S-1	AC230V	GYM40S-3~~~GYM150S-3	Electronic limit
GYK-54Y	AC230V	GYM50~~~GYM100	Mechanical limit
GYK-54SY	AC400V	GYM40S~~~GYM2000S	Mechanical limit
GYK-55Y	AC230V	GYM50~~~GYM100	Electronic limit
GYK-55SY	AC400V	GYM40S~~~GYM2000S	Electronic limit
GYK-56S-1	AC230V	GYM40S-3~~~GYM150S-3	Electronic limit
GYK-91Y	AC230V	GYM50~~~GYM100	Mechanical limit
GYK-91SY	AC400V	GYM40S~~~GYM2000S	Mechanical limit
GYK-92Y	AC230V	GYM50~~~GYM100	Electronic limit
GYK-92SY	AC400V	GYM40S~~~GYM2000S	Electronic limit
GYK-93S-1	AC230V	GYM40S-3~~~GYM150S-3	Electronic limit
GYK-95S-1	AC230V	GYM200S-3~~~GYM650S-3	Electronic limit
GYK-96S-1	AC400V	GYM40S~~~GYM650S	Electronic limit
GYK-93S-2	AC230V	GYJ40~~~GYJ100	Electronic limit
GYK-95S-2	AC230V	GYJ150	Electronic limit
GYK-96S-2	AC400V	GYJ40~~~GYJ150	Electronic limit
GYK-56SF	AC230V	GYM50SF~~~GYM200SF	Electronic limit
GYK-93SF-5	AC230V	GYJ-SF-550~~~GYJ-SF-750	Electronic limit
GYK-93SF-6	AC230V	GYJ-SF-1500/GYW-SF-1500	Electronic limit
GYK-93SF-7	AC230V	GYJ-SF-2200/GYW-SF-2200	Electronic limit
PT03SA	AC400V	Swing docking leveler control	-
PT11S	AC400V	Telescopes docking leveler control	-
PT12S	AC400V	Telescopes docking leveler control	-
GYK-PTS02	AC400V	G40S/G70S/GYM60S/GYM100S	Electronic limit
GYK-PTS07	AC400V	G40S/G70S/GYM60S/GYM100S	Electronic limit
GYK-PTS03	AC400V	G40S/G70S/GYM60S/GYM100S	Electronic limit
GYK-56SFPT	AC230V	GYM50SF~~~GYM200SF	Electronic limit
GYF100	AC400V	GYF100	Electronic limit

SLIDING
Door Operator
(AC Motor)

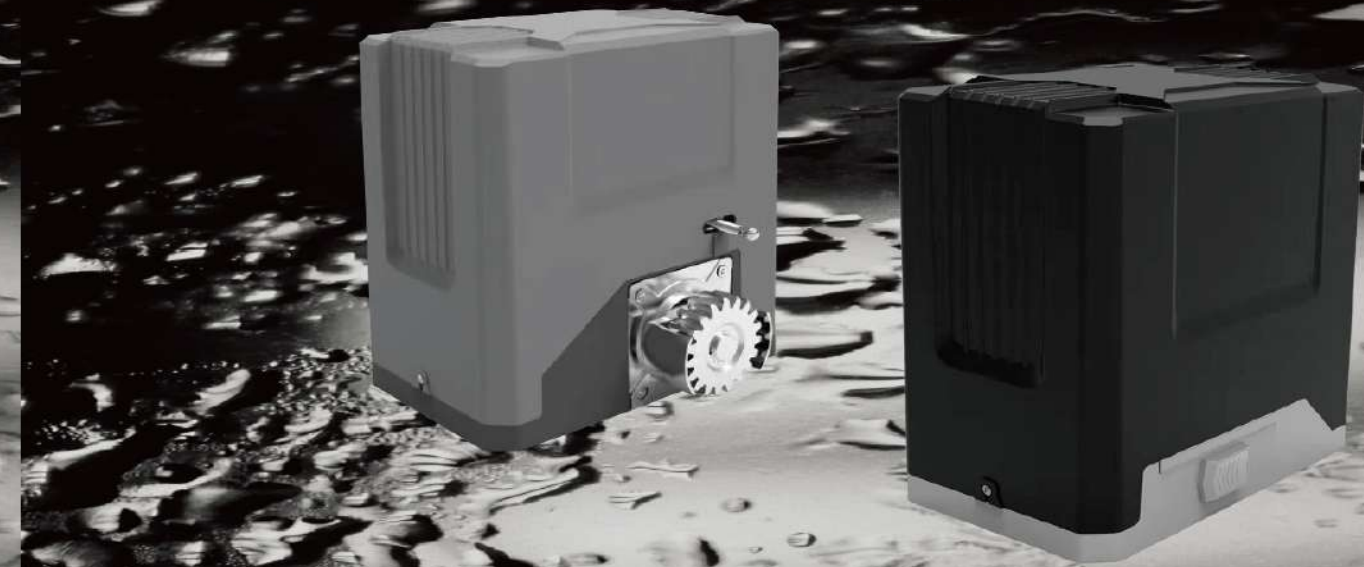

■ **Performance Parameter**

Model	PYM600	PYM800	PYM1000	PYM1500	PYM2500
Rated Power	280W	370W	400W	550W	850W
Max.Output torque	10N.m	18N.m	22N.m	35N.m	45N.m
Non-Load Working time	15min	15min	15min	15min	15min
Weight for Door	600Kg	800Kg	1000Kg	1500Kg	2500Kg
Power Supply	AC220V				
Thermal Protection	135°C				
Reducer Ratio	1 : 25 (1:30)				
Moving RPM	12.5m/min. (Optional 21 Teeth 14.5m/min.)				
Lubrication	Oil Grease				
Noisy Unit	≤58dB				
Quick Release	key Release				
Limit Model	Magnetic or Spring				
Outputs Gear	Module 4 18Teeth (Optional 21Teeth)				
Ambient temperature	-20°C ~ +75°C				
Working Circle	S2 20%				
IP Rate	IP54				
Frequency	433.92 MHz				
Max. Remote	25				
Remote Mode	3-Button Control or 1-Button Control				
Remote Distance	Above 30m				
PCB Parameters	Max.Currancy:5A Fuse : AC220V5A				

■ **Magnet Limit Switch Type**



■ **Spring Limit Switch Type**



■ **Spring Limit Switch Type**



photocell



Remoter Transmitters



Strobe Light Wall Mount



M4-Galvanized Gear Rack
12*30*1000mm weight: 2.8Kg (4PCS/CTN)
18*30*1000mm weight: 2.1Kg (4PCS/CTN)
8*30*1000mm weight: 1.8 Kg (4PCS/CTN)



Wireless Keypad

ZK300DC

SWING Door Operator

(DC Motor)



ZK800/ZK1000

SWING Door Operator

(AC Motor)



Performance Parameter

Model	ZK300DC
Open or Close time	10s
Max Power	50W
Power Supply	AC 110V-240V 50/60Hz
Motor vantage	DC24V/24V
Max door weight	300kg
Max door Width	3m
Control voltage	24V
Motor Unload Speed	1500rpm
Runing Noise	<50dB
Temperature Range(°C)	(-40 °C ~ +85 °C)
Relative Humidity	<90%
Protection Level	IP54
Remote Distance	>30m



- 1 CONTROL UNIT
- 2 GATE OPENER
- 3 SWING GATE
- 4 ALARM LAMP (OPTIONAL)
- 5 WIRELESS KEYPAD (OPTIONAL)
- 6 INFRARED SENSOR (OPTIONAL)
- 7 REMOTE CONTROL
- 8 SAFETY STOPPER



Characteristics

- DC motor, support backup battery.
- Optional single/double gate mode.
- No limit switch, stop in obstacle, need stop block.
- Automatic closing function with adjustable time (0~90s).
- Slow start and stop, smooth operation, no inertia.
- Manual release design for emergency purpose.
- Alarm lamp, photo beam & safety beam interface.
- Support access control system to realize automatic identification and access control.

Performance Parameter

Model	ZK800	ZK1000
Open or Close time	17s	17s
Max Power	200W	250W
Power Supply	AC 110V-240V 50/60Hz	
Motor vantage	AC230V	AC230V
Max door weight	800kg	1000kg
Max door Width	4m	5m
Control voltage	24V	24V
Motor Unload Speed	1500rpm	1500rpm
Runing Noise	<50dB	<50dB
Temperature Range	(-40 °C ~ +85 °C)	(-40 °C ~ +85 °C)
Relative Humidity	<90%	<90%
Protection Level	IP54	IP54
Remote Distance	>30m	>30m



- 1 CONTROL UNIT
- 2 GATE OPENER
- 3 SWING GATE
- 4 ALARM LAMP (OPTIONAL)
- 5 WIRELESS KEYPAD (OPTIONAL)
- 6 INFRARED SENSOR (OPTIONAL)
- 7 REMOTE CONTROL
- 8 SAFETY STOPPER



Characteristics

- AC motor, support backup battery.
- Optional single/double gate mode.
- No limit switch, stop in obstacle, need stop block.
- Automatic closing function with adjustable time (0~90s).
- Slow start and stop, smooth operation, no inertia.
- Manual release design for emergency purpose.
- Alarm lamp, photo beam & safety beam interface.
- Support access control system to realize automatic identification and access control.

FOLDING Door Operator

(AC Motor)

FK400



FOLDING Door Operator

(AC Motor)

FK800/FK1000
FK600DC



■ Performance Parameter

Model	FK400
Open or Close time	10s
Max Power	260W
Power Supply	AC 110V-240V 50/60Hz
Motor voltage	AC230V
Max door weight	300kg
Max door Width	3m
Control voltage	24V
Motor Unload Speed	1500rpm
Running Noise	<50dB
Temperature Range(°C)	(-40 °C ~ +85 °C)
Relative Humidity	<90%
Protection Level	IP54
Remote Distance	>30m

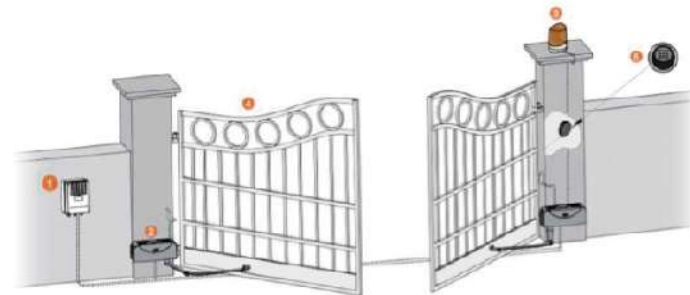

- 1 CONTROL UNIT
- 2 GATE OPENER
- 3 ALARM LAMP (OPTIONAL)
- 4 SWING GATE/INDUSTRIAL FOLDING GATE
- 5 WIRELESS KEYPAD (OPTIONAL)
- 6 REMOTE CONTROL
- 7 CRANK ARM/CONNECTING ROD



■ Performance Parameter

Model	FK800	FK1000	FK600DC
Open or Close time	10s	10s	10s
Max Power	150W	350W	180W
Power Supply	AC 110V-240V 50/60Hz	AC 110V-240V 50/60Hz	AC 110V-240V 50/60Hz
Motor voltage	AC230V	AC230V	DC24V
Max door weight	800kg	1000kg	600kg
Max door Width	3m	5m	3m
Control voltage	24V	24V	24V
Motor Unload Speed	1500rpm	1500rpm	1500rpm
Running Noise	<50dB	<50dB	<50dB
Temperature Range(°C)	(-40 °C ~ +85 °C)	(-40 °C ~ +85 °C)	(-40 °C ~ +85 °C)
Relative Humidity	<90%	<90%	<90%
Protection Level	IP54	IP54	IP54
Remote Distance	>30m	>30m	>30m

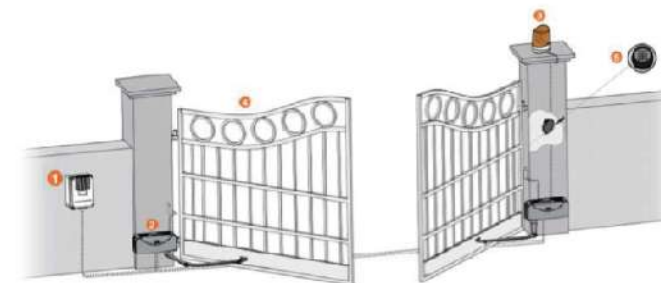

- 1 CONTROL UNIT
- 2 GATE OPENER
- 3 ALARM LAMP (OPTIONAL)
- 4 SWING GATE/INDUSTRIAL FOLDING GATE
- 5 WIRELESS KEYPAD (OPTIONAL)
- 6 REMOTE CONTROL
- 7 CRANK ARM/CONNECTING ROD



GARAGE Door Operator

(DC Motor)

CKM Series (600N~1800N)



GARAGE Door Operator

(AC Motor)

GYZ Series (1000N~1500N)



Performance Parameter

Model	CKM600N	CKM800N	CKM1000N	CKM1200N	CKM1500N	CKM1800N
Door size	8m²-10m²	10m²-12m²	12m²-14m²	14m²-18m²	18m²-20m²	21m²-25m²
Motor power	60W	80W	100W	120W	150W	200W
DC motor	24V/6N	24V/7N	24V/7N	24V/8N	24V/8N+	24V/8N+
Nominal voltage	220V ×(1±10%)VAC 50-60Hz					
Rated current	2.5A	3.3A	4.1A	5A	6.25A	8.3A
Light	LED					
Hand transmitter	2PCS include					
Transmitter Spec.	1、Rolling code technology ; 2、Frequency : 433.92MHz ; 3、Distance ≥30m ; 4、20 pcs remotes can be connected without external receiver					
Speed based on unloaded	Normal speed : 120-150mm/s			High speed : 150-180mm/s		
Security / safety protection technology	1: Reverse force when running against obstacle meet the European normative 2: Option with Photo beam ,code pad ,external receiver ,wire & wireless push button ,warning lights, battery backup etc. 3: within function of small door,soft star soft close . Self-lock function etc.					
Working temperature range	-20°C- +40°C	-20°C- +50°C	-20°C- +50°C	-20°C- +50°C	-20°C- +50°C	-20°C- +50°C
backup working hours	24 Hours					
Backup working time when power off	20 times on both up + down					
Certificate	CE,TUV					

Performance Parameter

Model	GYZ100-2	GYZ130-2	GYZ150S-3
Input Voltage	AC220V	AC220V	AC220V
Rated Power	370W	500W	550W
Startup Torque	1000N	1300N	1500N
No-load Running Time	10min	10min	15min
Maximum Door Weight	20m²	25m²	25m²
Mode of supportive power-control	Integrated machine		
Thermal Protective Temperature	120°C		
Retarding Mechanism	Gear reduction mechanism		
Lifting speed	16cm/s	16cm/s	16cm/s~25cm/s
Lubrication	Oil Lubrication		
Quick release	Quick Hand Release Rope		
Noise	≤58dB		
Track length	3m*3m or 3m*2m		
Maximum Travel Limit	5m Rail door (high) limit range less than 4.2 meters 6m Rail door (high) limit range less than 5.2 meters		
Type of limit switch	Electronic Limit		
Ambient Temperature	-20°C~+45°C		
Working System	S3 20%		
Protective level	IP44		
Total weight	15KG		

Dimensions

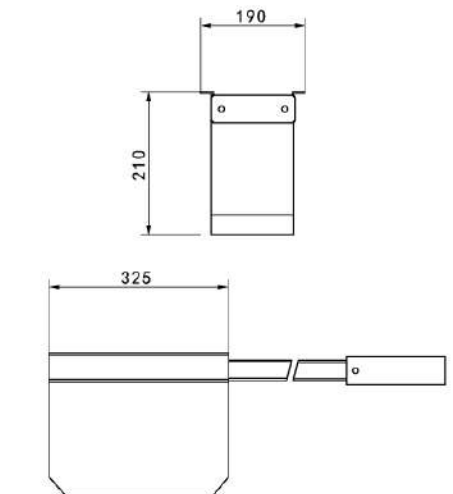

Characteristics

- The phase sequence automatic detection function,ensure the door a body in the right direction
- With a door in door interlock protection function interface
Can receive magnetism,entrance guard system,realizes the unmanned management,automatic open and close the doors
- Can set remig door inching functin. used for special occasions

BARRIER Boom Gate

(BLDC Motor)

DCSF Series (3m~6m)

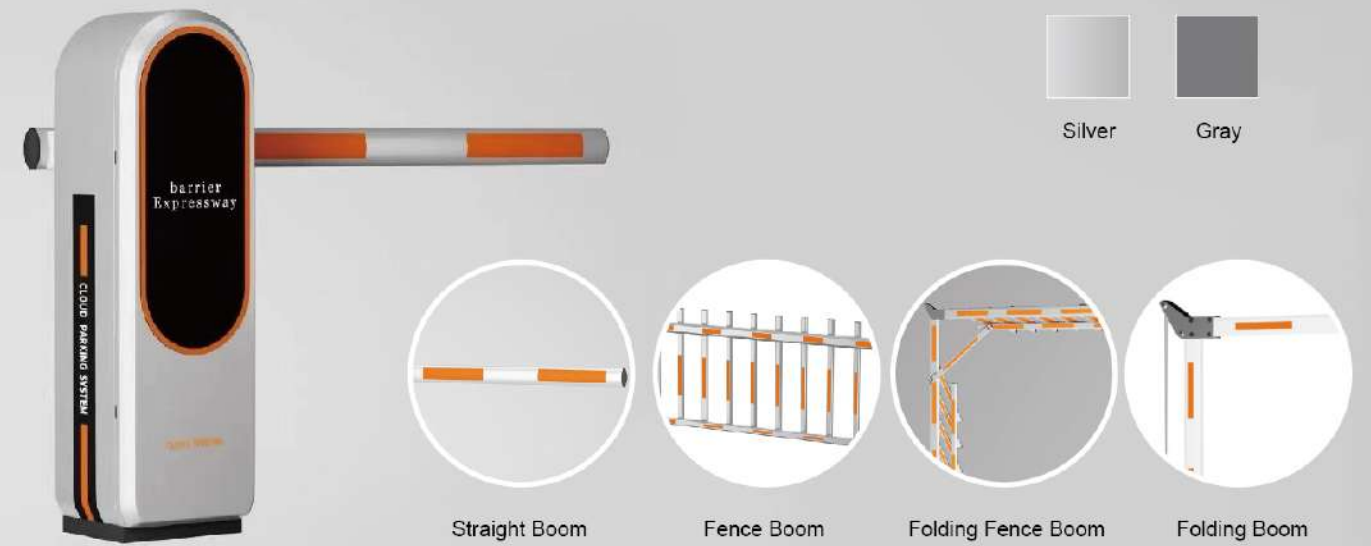

Performance Parameter

Model	DCSF3008	DCSF4015	DCSF5030	DCSF6050
Up and down time	0.8s	1.5s	3.0s	5s
Max Power	180W			
Power Supply	110V-240V			
Motor Method	BLDC Motor			
Control voltage	24V			
Motor Unload Speed	1500rpm			
Running Noise	<50dB			
Temperature Range(°C)	(-40 °C ~ +85 °C)			
Relative Humidity	<90%			
Protection Level	IP54			
Remote Distance	>30m			
Service Life	5000000 times			
Size	1035*320*220			
Weight	45			

Unit Model	Max Boom length			
	DCSF30	DCSF30	DCSF30	DCSF30
Straight Boom	3m	4m	5m	6m
Telescopic straight Boom	3m	4m	5m	6m
Fence Boom		3m	4m	5m
Folding Boom		3m	4m	5m
Folding Fence Boom			3m	4m
Circle Boom	3m	4m	5m	6m

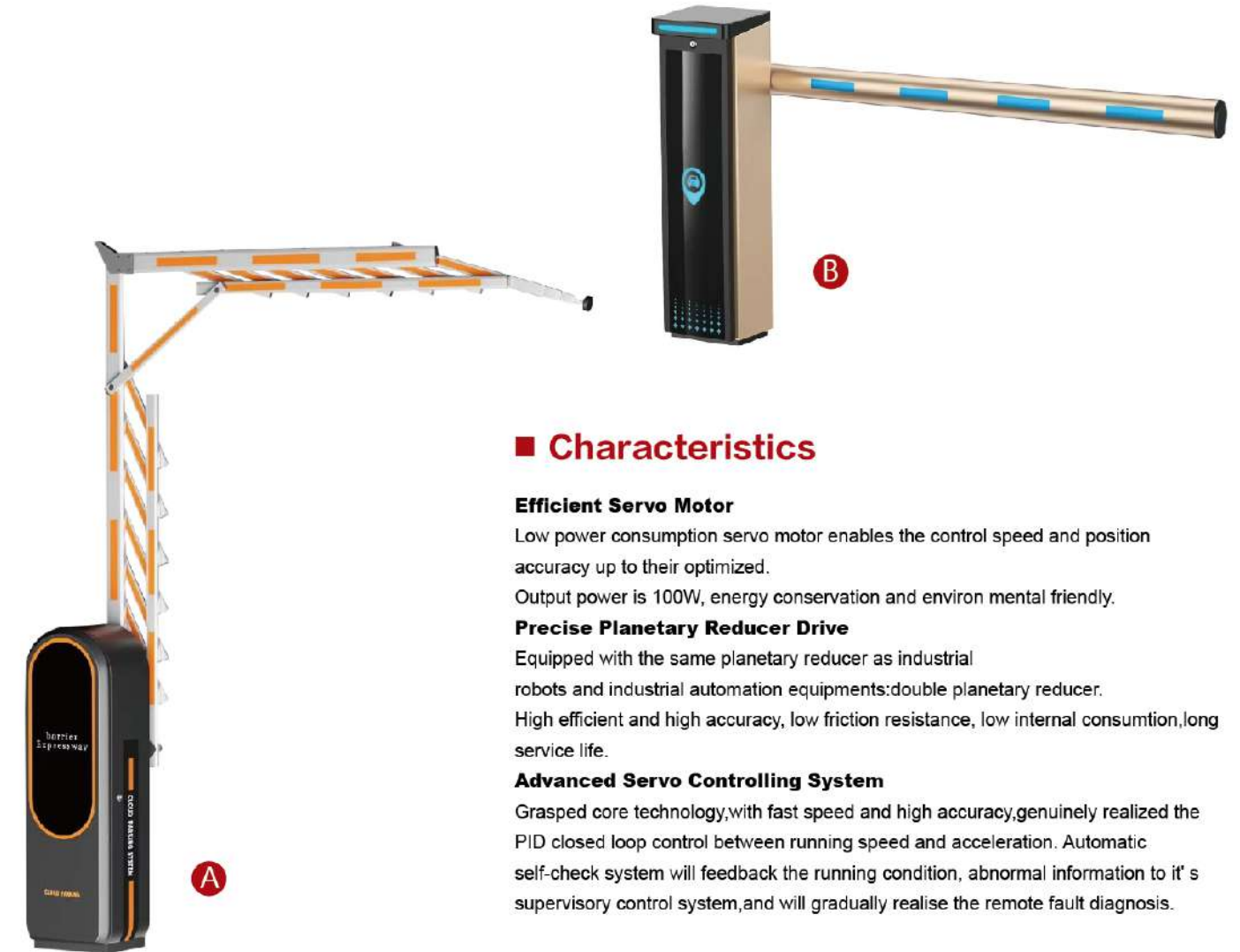

Characteristics

Efficient Servo Motor

Low power consumption servo motor enables the control speed and position accuracy up to their optimized.

Output power is 100W, energy conservation and environmental friendly.

Precise Planetary Reducer Drive

Equipped with the same planetary reducer as industrial robots and industrial automation equipments: double planetary reducer.

High efficient and high accuracy, low friction resistance, low internal consumption, long service life.

Advanced Servo Controlling System

Grasped core technology, with fast speed and high accuracy, genuinely realized the PID closed loop control between running speed and acceleration. Automatic self-check system will feedback the running condition, abnormal information to its supervisory control system, and will gradually realise the remote fault diagnosis.

Industrial Door Operator Components



With years of experience, we are dedicated to providing our partner with comprehensive solutions of gate controlling system. IDER DOORLIFTER'S components are carefully selected from various applications and capable of meeting multiple requirements.

Controlling Device



3-Button box: Indoor button switch when use of buttons can't be locked.



3-Button box lockable: Outdoor button switch when use of buttons can be locked



3-Button box: External 3-button controller used indoors only and the use of buttons can't be locked



Remote control Transmitters: Remote distance up to 30 meters.

Safety Device



Pneumo Switch With Spiral Cable:
Highly sensible adjusting switch connected with super-long high elastic spiral cord.



Wireless Pneumo Switch:
High sensible adjusting switch connected safety edge operation feedback from wireless signal



Infrared Optical Sensor Edge:
High sensible adjusting switch connected safety edge operation feedback from wireless signal



Infrared protective switch:
Traditional anti-clamp protection realized by infrared beams installed on both sides of the gate



Infrared protective switch:
Traditional anti-clamp protection realized by infrared beams installed on both sides of the gate



Loop Detector:
Highly sensible to the movements of human and vehicle or objects in the area by loop detector, giving instructions to the gate for its automatic open and close



Radar sensing switch:
All-weather sensing controller immune to the light or temperature changes, being reliable sensors that are popularly used in the world.



Alarming lights:
In the course of the open and close of the gate, an alarm flashes continuously to give warning signal



Air switch:
Installed in the controlling box to provide convenient protection upon power failure. Meanwhile it has protection on electricity leakage that makes sure of safety of the circuit of the controlling system and main unit when there is a leakage of electricity.

Accessory Device



1:1.3 retarding ratio accessory:
Chain connection is utilized for the connection between the door opener and crossbeam shaft, which reduces the gate's moving speed and increases the door-opener's lifting torque. It is suitable for applications where the crossbeam shaft's diameter is 25.4 mm.



Hexagonal shaft accessory:
Chain connection is utilized for the connection between the door opener and crossbeam shaft which reduces retarding ratio the gate's moving speed and increases the door-opener's lifting torque. it is suitable for applications where the crossbeam shaft's diameter is 32 mm or hexagonal crossbeam with in circle diameters of 32mm.

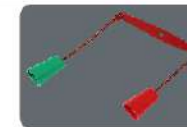

Release handle device: Suitable to be used for openers with swift releasing function.



Installation bracket: Installation fittings for the door-opener.

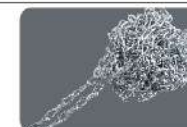

Looped chain:
Gate can be opened manually by operating the chain upon power failure, with ordinary chains and highly corrosion-resistance chains available for choice.